

# 2020MY Legacy (GC7) Fog Lamp Accessory Installation P# H451SAN000



 Ensure the VIN matches the work order and the vehicle date is in the lock period and there are no “Holds” on the vehicle for any reason.  
Ensure the vehicle calls for the accessory installation. Inspect the area where the accessory is to be installed and the vehicle for damages, etc. prior to all work.

**CAUTION: ACCESSORY INSTALLATIONS PERFORMED BY UNTRAINED PERSONS COULD RESULT IN SERIOUS INJURY TO THOSE PERSONS OR TO OTHERS.**

Subaru Work Instructions are intended for use by professional accessory installers ONLY. They are written to provide step by step accessory installation instruction for a fast paced production environment. Properly trained accessory installers have the equipment, tools , safety instructions and know-how to do the job correctly and safely. Included in this information are the use of “special” accessory installation fixtures and templates that are not available to the Retailers or general public. Please refer to the Retailer Installation Instructions found in Subaru Tech Info System (STIS).

# 2020MY Legacy (GC7) Fog Lamp Accessory Installation P# H451SAN000

Inspect the Fog Lamp Kit parts to ensure no missing parts or part defects:

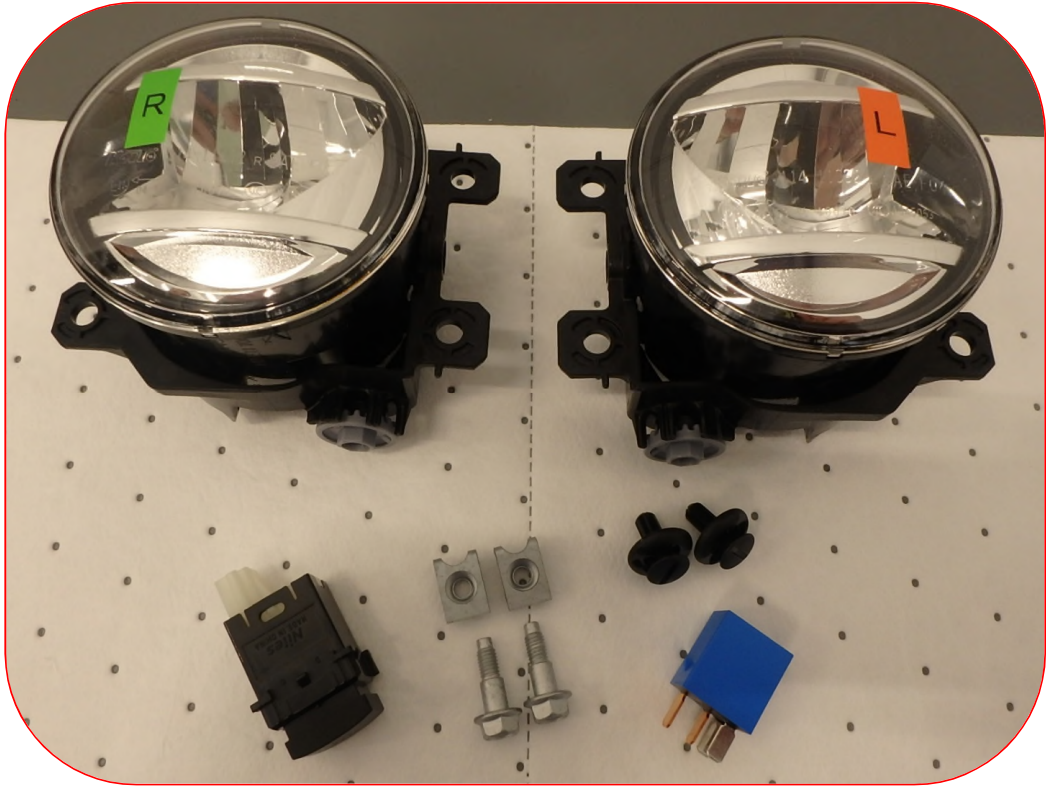

The fog lamp assembly is the different for RH  and LH  sides.

**STOP** **Stop:** Damage may occur to the vehicle/part. Do not proceed until process has been complied with.

**WHA** **Work Hazard Analysis (WHA):** Operator safety-Use caution to avoid risk of injury.

**!** **Caution:** A process that must be carefully observed in order to reduce the risk of damage to the accessory/vehicle and to ensure a quality installation.

**||** **Revision Mark/Highlight:** This mark highlights a change in installation with respect to the previous issue.

**WIT** **Work Instruction Training (WIT):** Key point that designates an important step to ensure the quality of the installation.

**♻️** **Recycle:** Item to be recycled.

**S** **Safety Torque -** This mark indicates that a torque is related to safety.

| Kit Contents |  |  |  |
|--------------|--|--|--|
|              |  |  |  |
|              |  |  |  |

# 2020MY Legacy (GC7) Fog Lamp Accessory Installation P# H451SAN000

## Required Tools and Supplies

- Clip removal tool
- ¼" drive torque wrench (in. lbs.)
- #2 Phillips Screwdriver
- Small flat blade screw driver (optional)
- ¼" drive ratchet
- ¼" drive 4" Extension
- 10mm socket
- Nylon trim tool
- Scotty Peeler Tool (Optional)
- Clean towels (Micro-fiber)
- 99% Alcohol
- Paint "torque" marker
- Interior protection cover
- Window Glass Cleaner (Optional)



# 2020MY Legacy (GC7) Fog Lamp Accessory Installation P# H451SAN000

## Disconnect the Negative Battery Cable



1. Open the hood and use the prop rod to hold the hood open.

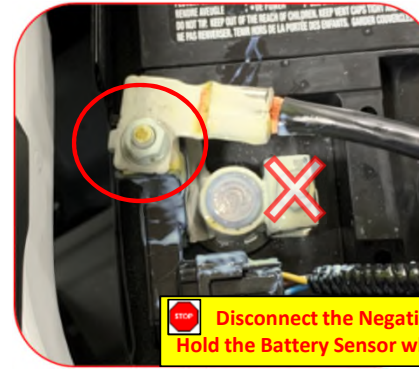

**STOP** Disconnect the Negative Battery Cable Nut Only.  
Hold the Battery Sensor when loosening the nut.



2. Using a 1/4" drive ratchet and 10mm socket, loosen the negative battery cable nut.

3. When loosening, be sure to hold the battery sensor as shown above. Failure to properly hold the sensor can cause damage to the sensor.



4. Once loosened, remove the nut and the cable from the stud. Position / protect the negative cable so it cannot accidentally touch body ground or the negative battery terminal. Allow (60) seconds before the next installation step to ensure the airbag power supply is discharged.

**⚠** Carefully remove the negative battery cable from the battery stud only. Do not allow the negative cable accidentally ground during the installation.

# 2020MY Legacy (GC7) Fog Lamp Accessory Installation P# H451SAN000

## Install the Fog Light Relay in the Relay Box

1. Locate the relay box under the hood on the right side of the vehicle in the engine compartment.
2. Remove the plastic lid and locate the slot #4 as shown.
3. Insert the Fog Light Relay in the Relay Box Slot #4.
4. Reinstall the relay box top and ensure it is properly seated in place.

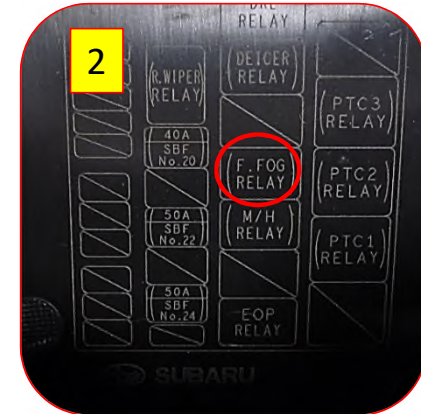

Slot #4 (Fog Lamp Relay Location)

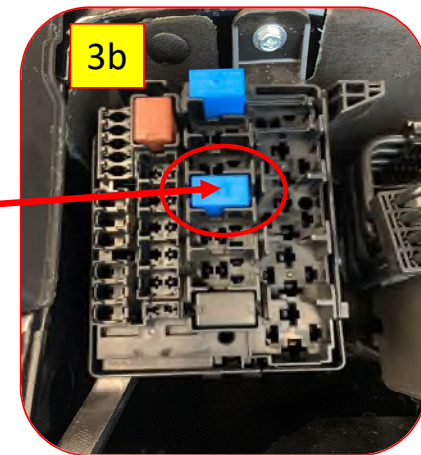
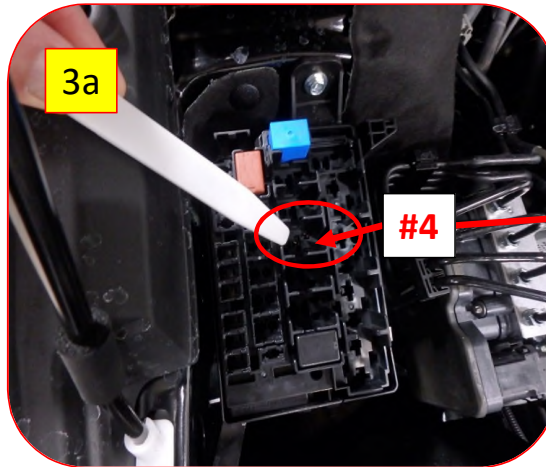

# 2020MY Legacy (GC7) Fog Lamp Accessory Installation P# H451SAN000

## Access the Fog Light Area

1. Remove (3) large clips using a nylon trim tool from the RH lower apron area to gain access to the inner front bumper area to install the RH fog lamp assembly.
2. Set all 3 clips aside for reinstallation.
3. Unseat the lower apron by pulling downward.



 The clips will be reused so be careful not to damage them during removal.

# 2020MY Legacy (GC7) Fog Lamp Accessory Installation P# H451SAN000

## Remove the LH and RH center Fog Lamp Bezel front bumper covers

1. Carefully remove the two Philips head screws from the back side of the cover that hold the RH fog light center light bezel in place.
2. Once the (2) screws have been removed, remove the center light bezel by applying light pressure inward on the bezel.
3. Dispose of the cover responsibly. 
4. Using a clean towel, clean around the fog light bezel area opening on the bumper both front RH side.

• Note: Be careful not to damage the fog lamp opening when removing the cover.

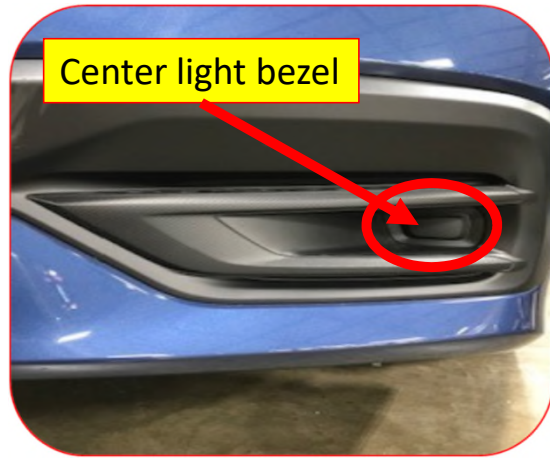

# 2020MY Legacy (GC7) Fog Lamp Accessory Installation P# H451SAN000

## Install the LH and RH Fog lamp assemblies

- The fog lamp assemblies are different for RH and LH sides.
- The (2) outer tabs fit into the slots on the outside of the front bumper skin and the clip at the top. The lower tab is where the 10mm bolt secures the assembly in place.

The fog lamp assemblies are different for RH and LH sides. See the color code

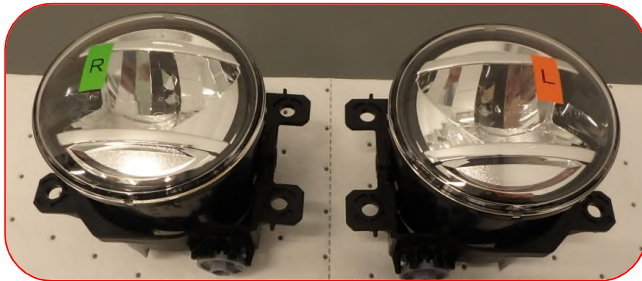

# 2020MY Legacy (GC7) Fog Lamp Accessory Installation P# H451SAN000

## Install the LH and RH Fog lamp assemblies

1. Working from under the RH front bumper area, install the "J" nut on the bottom inner front bumper skin location from the opening inner side.
2. The "J" nut threaded portion goes to the outside. Ensure the "J" nut is fully seated with the bumper skin locating tab .

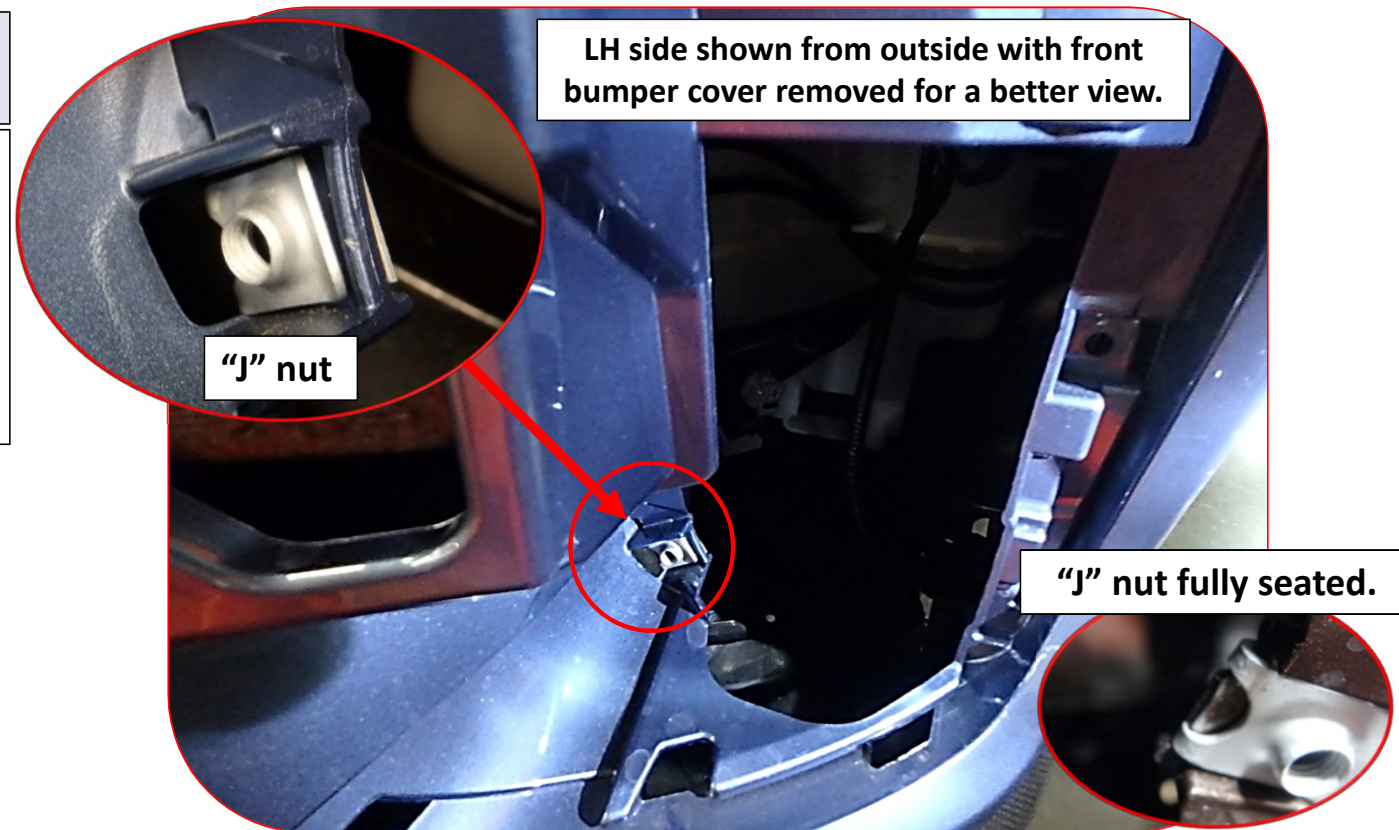

 Ensure the "J" nut and Fog Lamp tabs are properly installed in the front bumper areas as shown

## 2020MY Legacy (GC7) Fog Lamp Accessory Installation P# H451SAN000

### Locate the LH and RH Fog light prewired connectors

1. Locate the RH fog light connector in the front bumper fog light openings. Remove the connectors and harness from the "blue" break away tape.

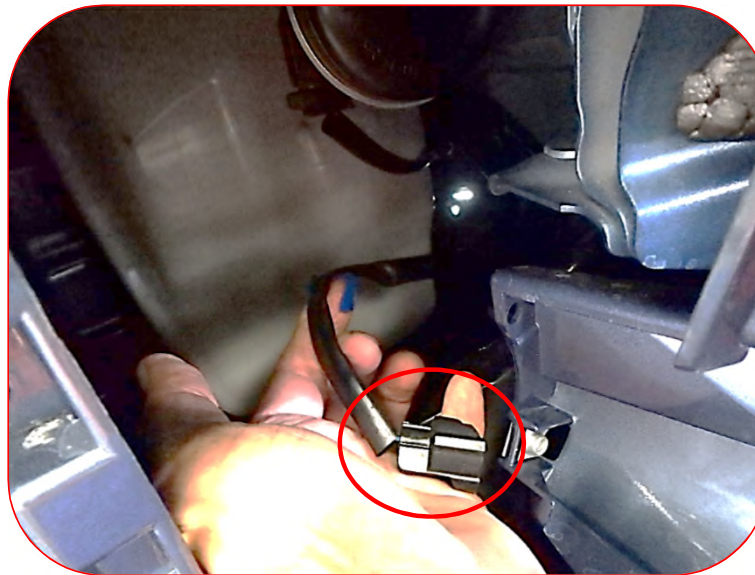

**⚠ Never use sharp tools such as a box cutter or side cutting pliers or razor blades to cut the break-away tape. Wiring can be accidentally cut or wire covering permanently damaged as a result of using sharp edged tools. Only use blunt tools such as a tape end wrapped flat blade screw driver. For "Pink" or "Black" break-away tape, un-wrap the tape to remove it because it is hard to break away and permanent damage can occur if not handled with proper care.**

# 2020MY Legacy (GC7) Fog Lamp Accessory Installation P# H451SAN000

## Install the RH Fog lamp assembly

1. Locate the O.E. fog lamp connector and plug in the connector to the fog lamp assembly.
2. Listen for the audible “click” of the connector lock. Ensure proper connection by carefully push pull push on the connector.



**⚠ Never use sharp tools such as a box cutter or side cutting pliers or razor blades to cut the break-away tape. Wiring can be accidentally cut or wire covering permanently damaged as a result of using sharp edged tools. Only use blunt tools such as a tape end wrapped flat blade screw driver. For “Pink” or “Black” break-away tape, un-wrap the tape to remove it because it is hard to break away and permanent damage can occur if not handled with proper care.**

## 2020MY Legacy (GC7) Fog Lamp Accessory Installation P# H451SAN000

### Install the RH Fog lamp assemblies

1. Working from under the RH front bumper area, carefully position the fog lamp to the inside of the front bumper skin opening.
2. Carefully slide the (2) outer tabs of the fog lamp assembly into the (2) front bumper skin slots.

 **Ensure the correct Fog Lamp Assembly is properly installed in the front bumper area as shown.**



 **Ensure the Fog Lamp tabs are properly installed in the front bumper areas as shown**

## 2020MY Legacy (GC7) Fog Lamp Accessory Installation P# H451SAN000

### Install the RH and LH Fog lamp assemblies

1. Working from under the RH front bumper area and using (1) push pin clip, insert the clip from the inner front bumper skin opening.
2. Push the (1) clip through the top inner tab opening in the fog lamp assembly through the opening in the front bumper skin.
3. Ensure the push pin is properly locked in place by moving the fog lamp assembly back and forth.

 Ensure the correct Fog Lamp Assembly is properly installed in the front bumper area as shown.



# 2020MY Legacy (GC7) Fog Lamp Accessory Installation P# H451SAN000

## Install the RH Fog lamp assembly

1. Using the access from under the front bumper skin, position the (1) 10mm bolt through the lower inner fog lamp tab and into the "J" nut.
2. Using a 10mm socket and an extension start the 10mm bolt by hand to ensure the bolt threads are properly positioned.
3. Using a ratchet, extension and 10mm socket loosely tighten the 10mm bolt in place.
4. Using the torque wrench, torque the 10mm bolt to 66 in. lbs.
5. Using a torque marker apply a torque mark on the bolt head.

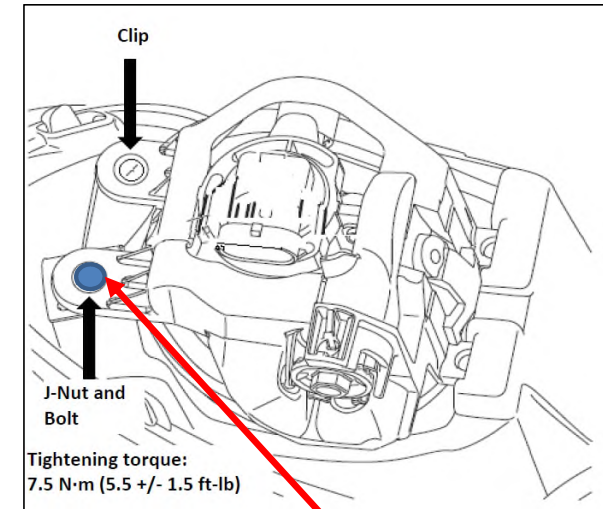
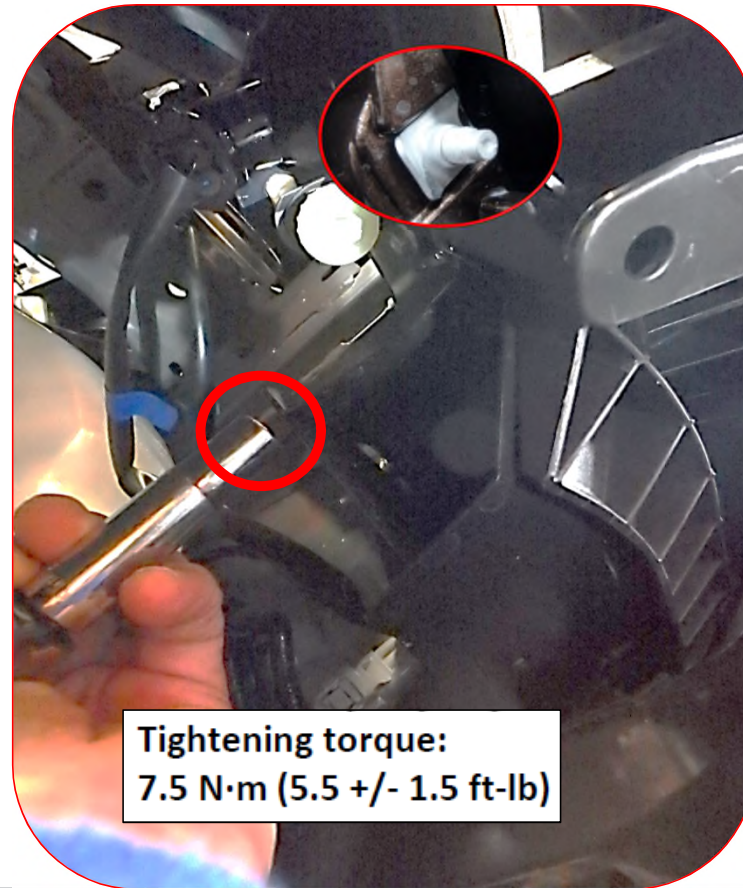

**Torque mark**

# 2020MY Legacy (GC7) Fog Lamp Accessory Installation P# H451SAN000

## Access the Fog Light Area

1. Properly reposition the RH lower apron and reinstall the saved (3) large clips.
2. Carefully remove the identification label on the fog lamp lenses and clean with alcohol and a clean towel.
3. Repeat slides 6-15 for the LH fog light installation.

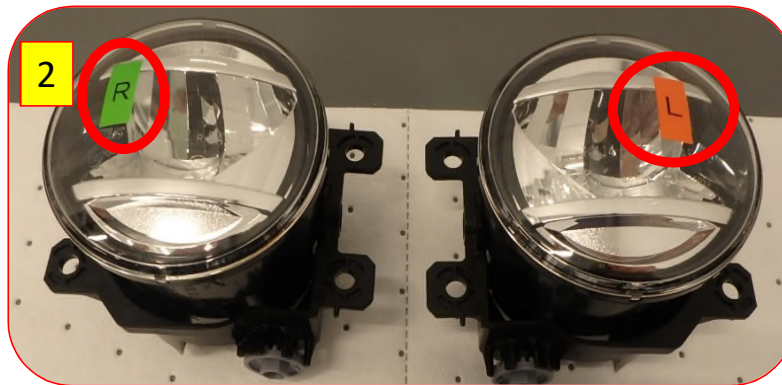

# 2020MY Legacy (GC7) Fog Lamp Accessory Installation P# H451SAN000

## Removing LH lower dash

1. Cover sill plate with protection cover.
2. Remove driver's lower kick panel, place aside for reinstallation.
3. Remove LH side panel by inserting nylon trim tool at bottom of access notch, place the panel aside for reinstallation.
4. Remove (2) screws on the LH and RH sides of the lower dash panel.
5. Save the screws.

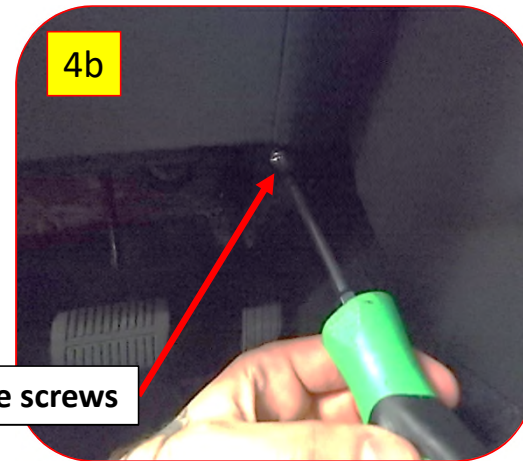
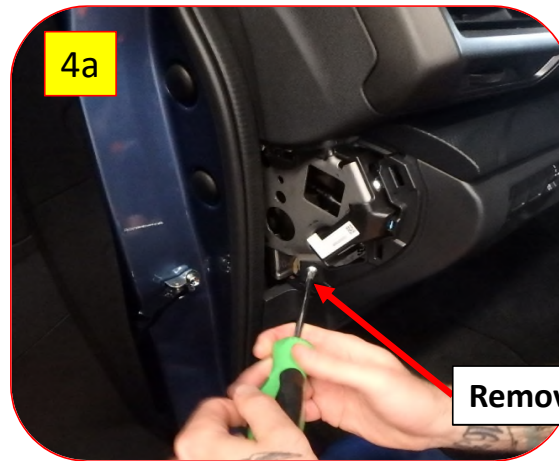

# 2020MY Legacy (GC7) Fog Lamp Accessory Installation P# H451SAN000

## Removing LH lower dash

1. Carefully unseat the lower dash panel by pulling straight out to disengage (16) blue clips.
2. Carefully using trim tool, unplug all switch connectors.
3. Place lower dash panel on a clean dry protected surface.



# 2020MY Legacy (GC7) Fog Lamp Accessory Installation P# H451SAN000

## Install the Fog Lamp Switch

1. Locate the lower right blank switch cover on the lower dash panel.
2. Using a nylon trim tool or Scotty Peeler Tool, carefully spread the clips to allow the blank cover to be removed.
3. Dispose/ recycle the switch blank cover. ♻️

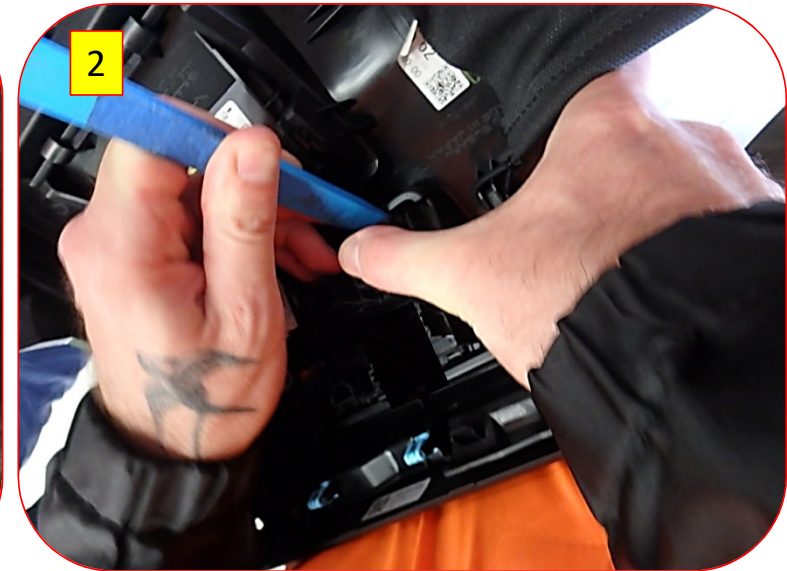
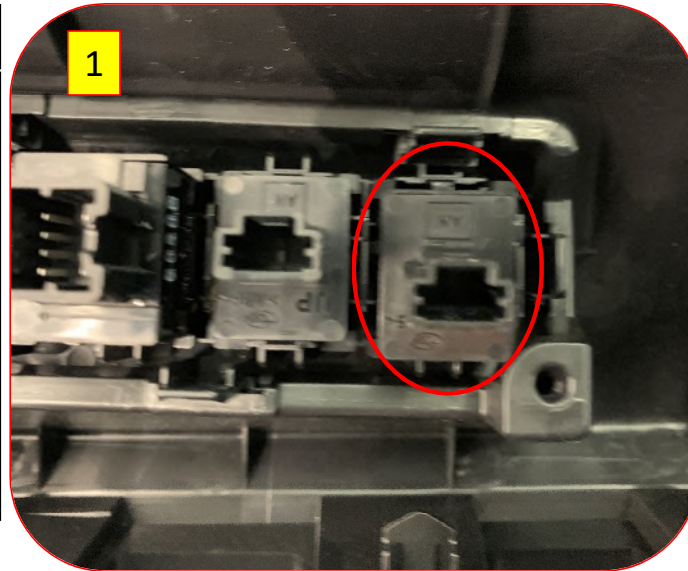

## 2020MY Legacy (GC7) Fog Lamp Accessory Installation P# H451SAN000

### Install the Fog Lamp Switch

1. Install the fog lamp switch. It only fits in the correct position.
2. Listen for the audible “snap” sound when the switch is seated in place.



## 2020MY Legacy (GC7) Fog Lamp Accessory Installation P# H451SAN000

### Install the Fog Lamp Switch

1. Locate the fog lamp switch harness connector that is “breakaway” taped to the harness.
2. Carefully remove the “breakaway” tape to release the (4 pin) fog lamp connector.

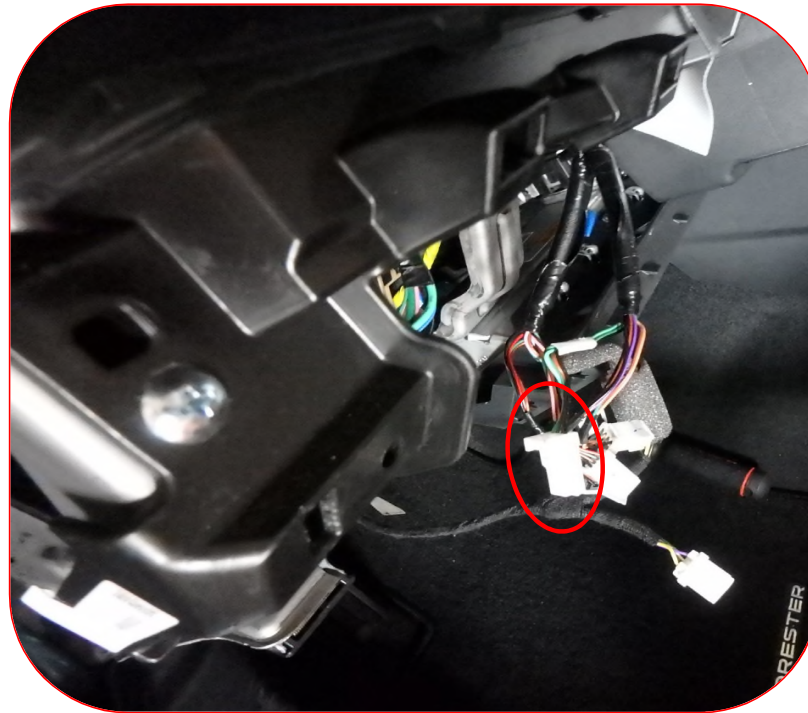

**⚠** Never use sharp tools such as a box cutter or side cutting pliers or razor blades to cut the break-away tape. Wiring can be accidentally cut or wire covering permanently damaged as a result of using sharp edged tools. Only use blunt tools such as a tape end wrapped flat blade screw driver. For “Pink” or “Black” break-away tape, un-wrap the tape to remove it because it is hard to break away and permanently damage can occur if not handled with proper care.

# 2020MY Legacy (GC7) Fog Lamp Accessory Installation P# H451SAN000

## Install the Fog Lamp Switch

1. Plug-in the fog lamp connector, ensure the connector is properly locked in place. Carefully push pull push on the switch connector.

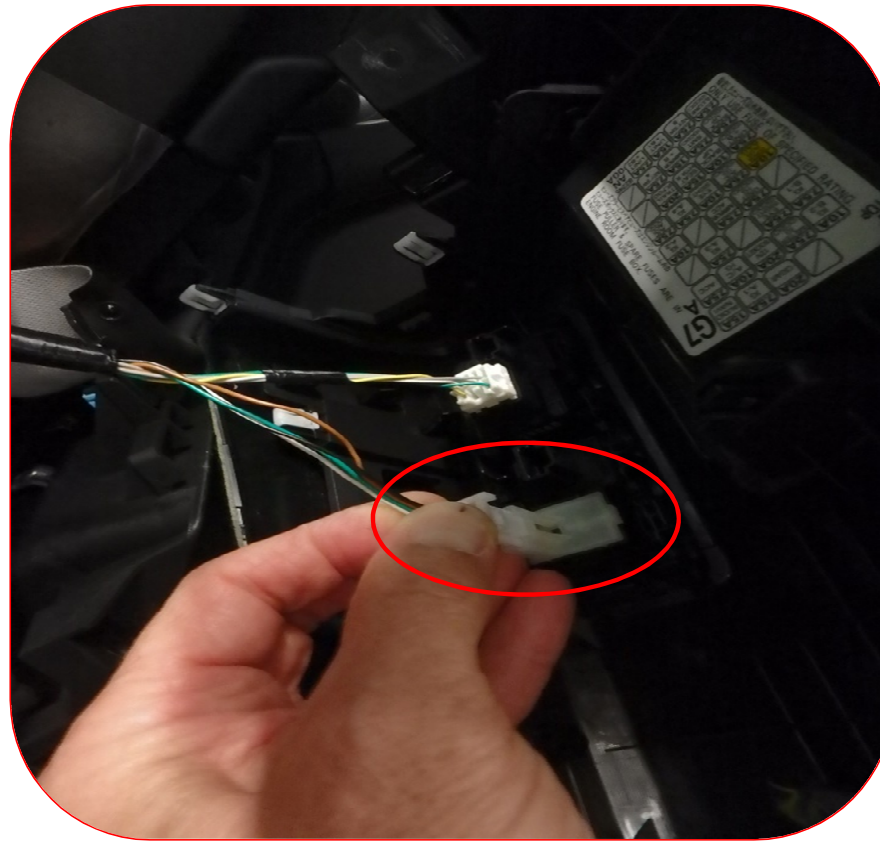

## 2020MY Legacy (GC7) Fog Lamp Accessory Installation P# H451SAN000

### Reinstall LH lower dash

1. Ensure the fog lamp switch is oriented correctly and secure in the lower right bottom corner of the switch panel.



# 2020MY Legacy (GC7) Fog Lamp Accessory Installation P# H451SAN000

## Reinstall LH lower dash

1. Carefully reconnect all switch connectors previously disconnected.
2. Carefully Realign the lower dash panel by aligning and securing (16) blue panel clips.

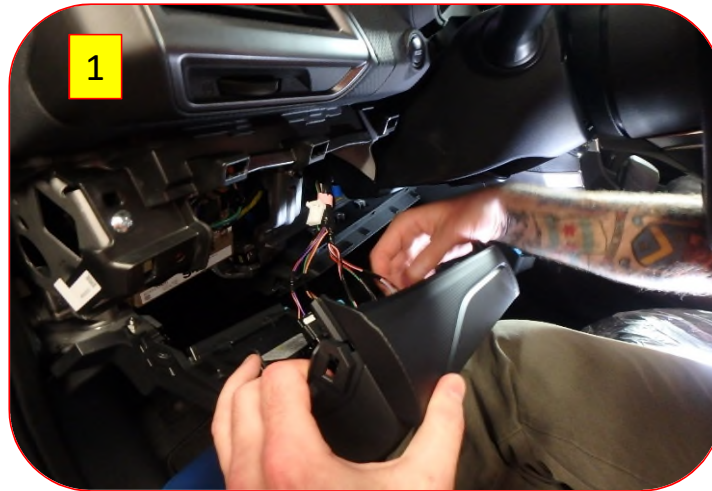

 Ensure the clips around the knee air bag are securely in place with no gaps.

# 2020MY Legacy (GC7) Fog Lamp Accessory Installation P# H451SAN000

## Reinstall the LH lower dash

1. Reinstall the (2) saved screws on the RH lower side of the panel and (1) screw on the LH side of the lower dash panel.
2. Reinstall the LH side cover panel by aligning the (4) blue clips.
3. Reinstall driver's lower kick panel.

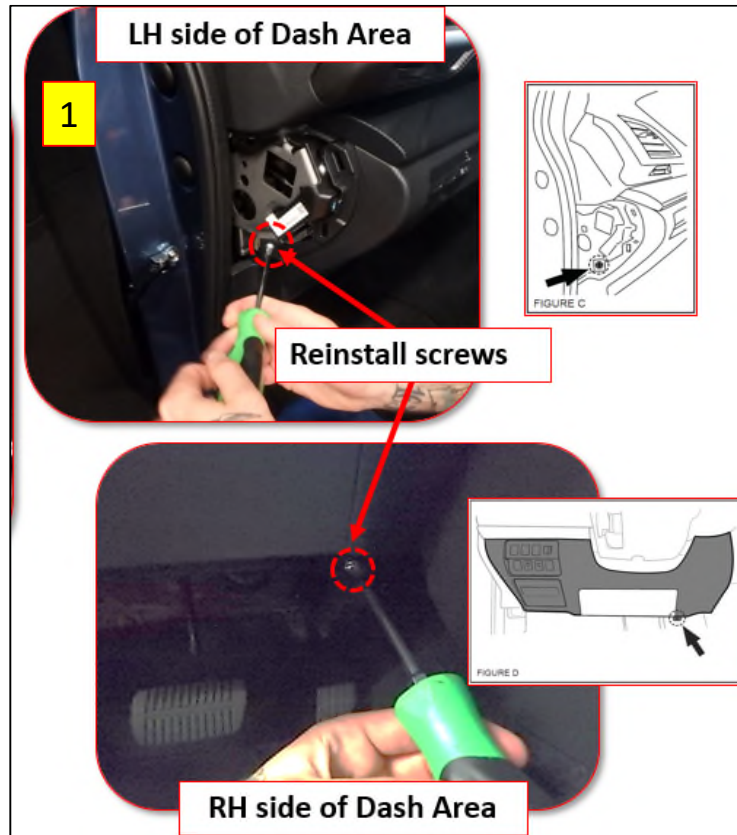

# 2020MY Legacy (GC7) Fog Lamp Accessory Installation P# H451SAN000

## Reconnect the Negative Battery Cable



1. Carefully, reconnect the Negative Battery Cable to the Negative Battery stud. Hand start nut to stud.



2. Using a 1/4" drive ratchet and 10mm socket, tighten the Negative Battery Cable nut. While tightening, be sure to hold the Battery Sensor, as shown. Failure to properly hold the sensor can cause damage to the sensor. Torque to 5.5 ft. lbs. or 66 in. lbs.

**⚠** Carefully install the Negative Battery Cable to the battery stud only. Do not allow the negative cable accidentally ground during the installation.

**STOP** Reconnect the Negative Battery Cable Only. Hold the Battery Sensor when tightening the nut. Torque to (5.5 ft. lbs. or 66 in. lbs.)



3. Paint mark the Negative Battery Stud, as shown.



4. Carefully disconnect the hood opening prop rod.



5. Store the rod back into position under the hood. Close the hood.

# 2020MY Legacy (GC7) Fog Lamp Accessory Installation P# H451SAN000

## Check Your Work:

- Turn “ON” the ignition with engine “Off” and turn the lights “ON” (low Beam) and press the fog light switch to the “ON” position.
- Ensure the fog light switch is illuminated with the dash illumination and will dim or brighten using the dimmer switch.
- Exit the vehicle and ensure the fog lamps are illuminated.
- Using the light switch (stalk) put the headlamps in “High Beam” mode and exit the vehicle and ensure the fog lamps are not illuminated.
- Check the area around the fog lamps for scratches including painted areas.
- Push on the fog lamp assemblies to ensure they are firmly installed in place.
- Check the dash area for soil marks and ensure all panels are securely in place.
- Ensure the power windows function properly.
- Verify all disconnected switches illuminate.

# 2020MY Legacy (GC7) Fog Lamp Accessory Installation P# H451SAN000

## Check the Power Window Up & Down Operation

### Initialization of Power Windows

If the power window automatic function does not operate properly, operate each window according to the following procedure in order to initialize the power window system.

1. Close the door.
2. Turn the ignition switch to the "ON" position.
3. Open the window completely and then press and hold down the power window switch for approximately (1) second.
4. Close the window completely and then pull and hold the power window switch for approximately (1) second.
5. Confirm the power window automatic functions operate properly.

