

General Notes

- Read through the fitting instructions before installation of the accessory. Install the accessory following the fitting instructions. Failure to do so may cause damage to the vehicle or the accessory.
- Ensure all recyclable discarded vehicle accessory components and packaging are recycled following local recycle regulations.
- It is always recommended that this accessory is fitted by a qualified automotive technician.
- Safely store and protect any removed vehicle components.
- Ensure all bare metal surfaces are protected using automotive bare metal primer and touch-up paint, or suitable automotive rust inhibitor.
- Remove all metal swarf and dust from all vehicle surfaces if the surface is used for accessory installation.

Safety Notes

- Check that all work practices comply with safety standards.
- Please wear appropriate clothing and use safety equipment.



Parts Supplied

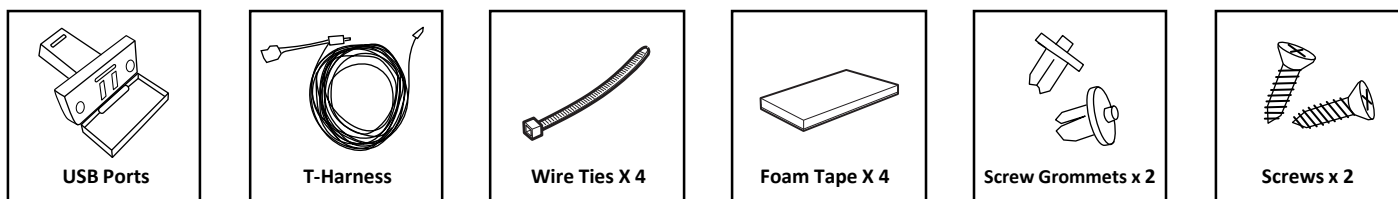

Tools Required

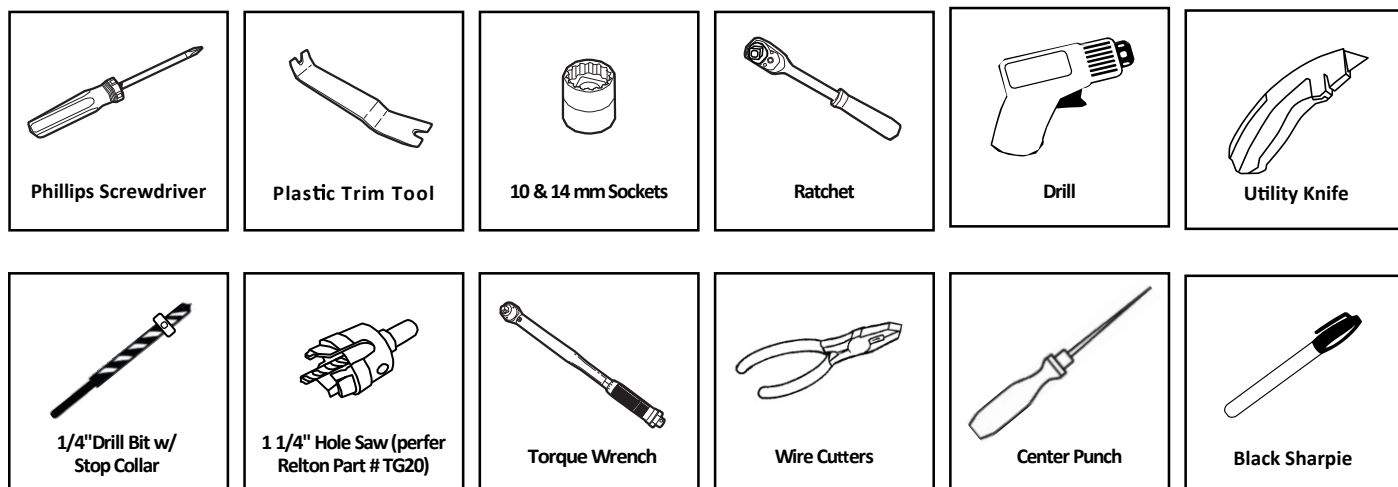

WIRING

1. Overview of system component locations and harness routing.

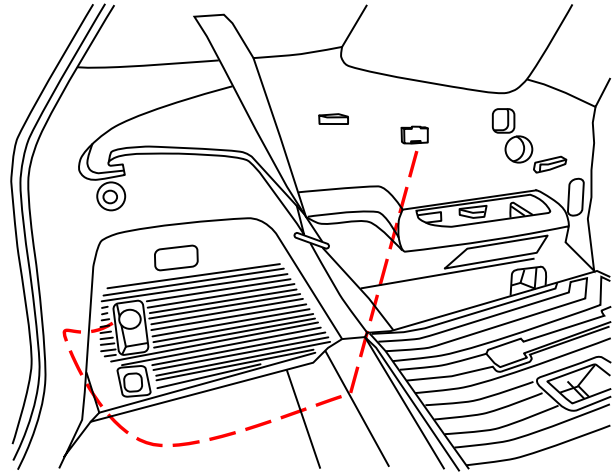

2. Disconnect Negative (-) battery cable.

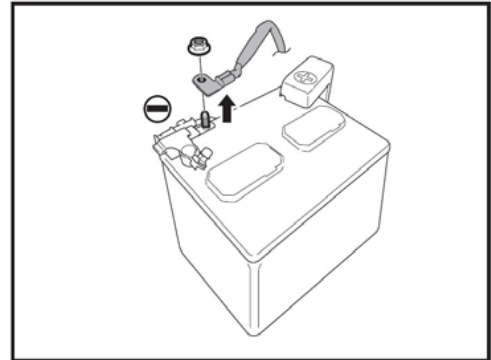

3. Fold 3rd row seats flat (lay forward). Remove cargo area cover (tonneau) if equipped. Remove the sub-floor center and RH side pieces. **Note:** For the following steps 3 through 8, follow the removal procedures outlined in the Subaru Ascent Service Manual.

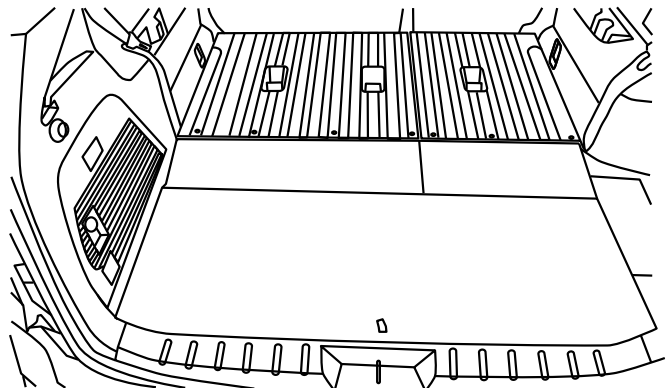

4. Remove (7) clips securing 3rd row seat flap and remove cargo tray ASSY.

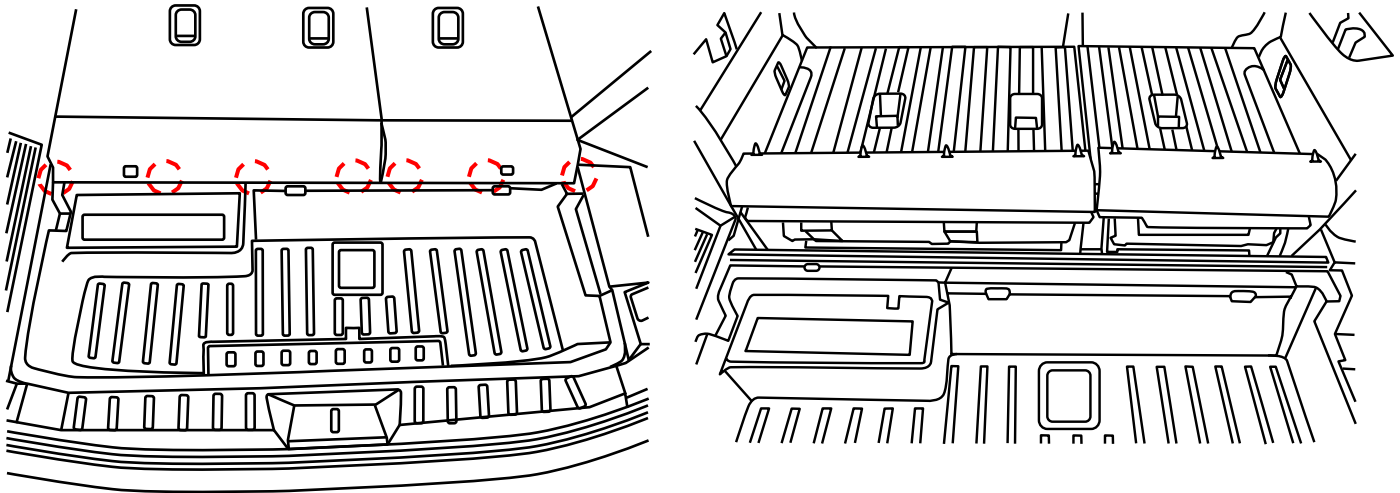

5. Remove the (4) clips to move the rear scuff panel ASSY.

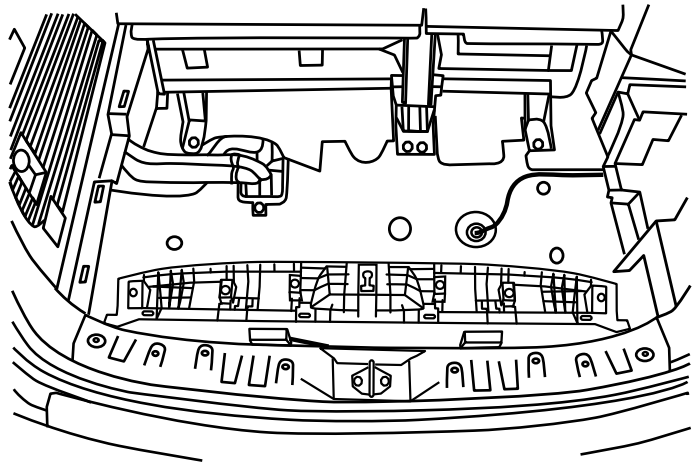

6. Remove the clips and remove the LH rear passenger door scuff cover. Use care when loosening the clips.

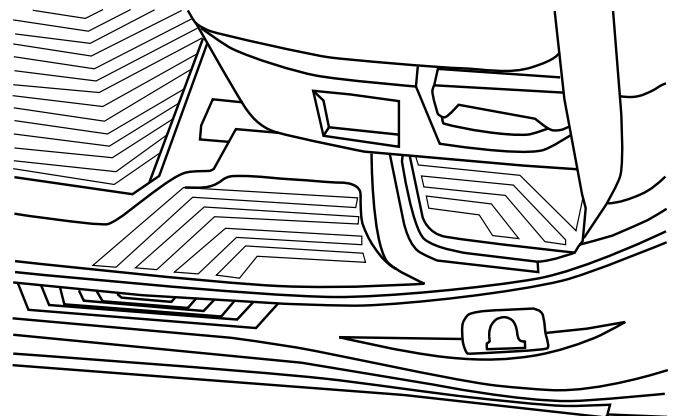
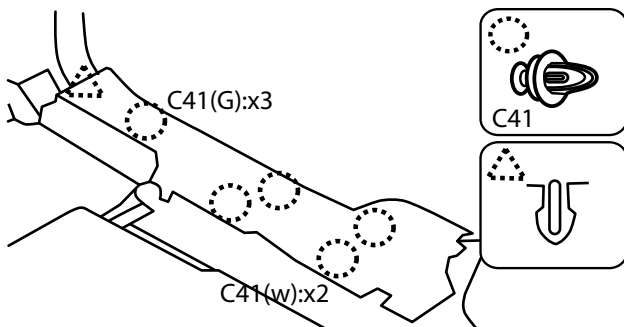

7. Remove the third row seat according to the procedure in the vehicle service manual.

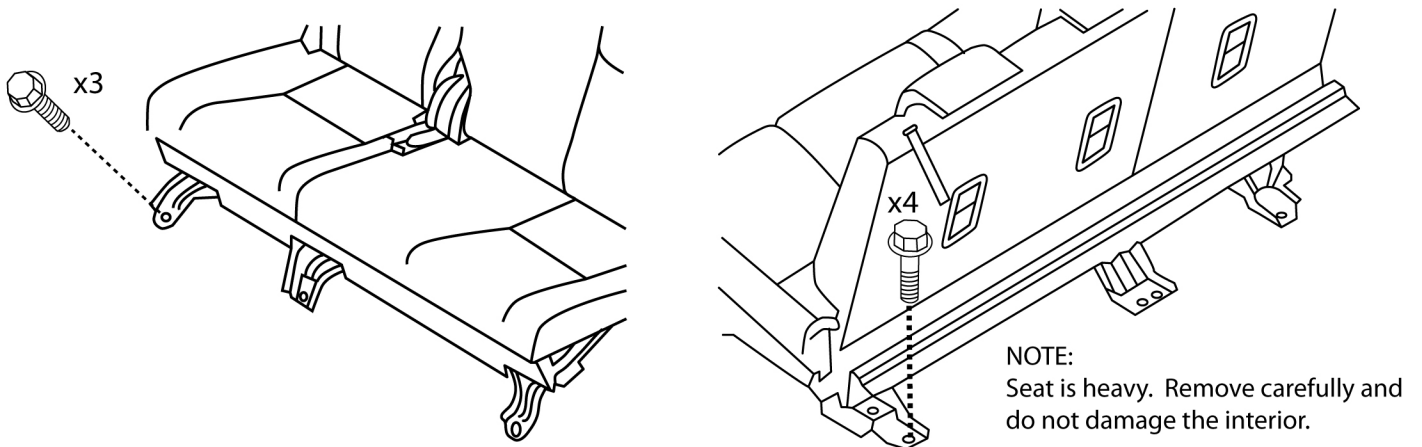

8. Remove (2) Philips screws (hidden under caps) and (2) 10mm bolts from trim panel apron.

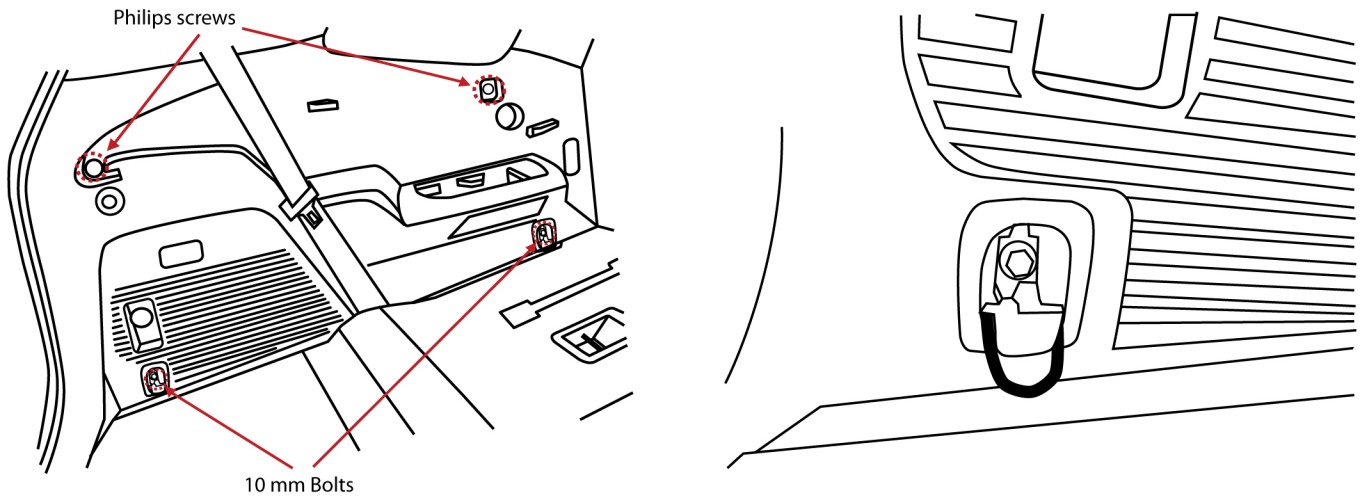

9. Carefully remove the (12) clips and catches to remove the LH cargo trim panel apron assembly. Disconnect the luggage lamp, 12V aux socket, and sensor connectors prior to removal.

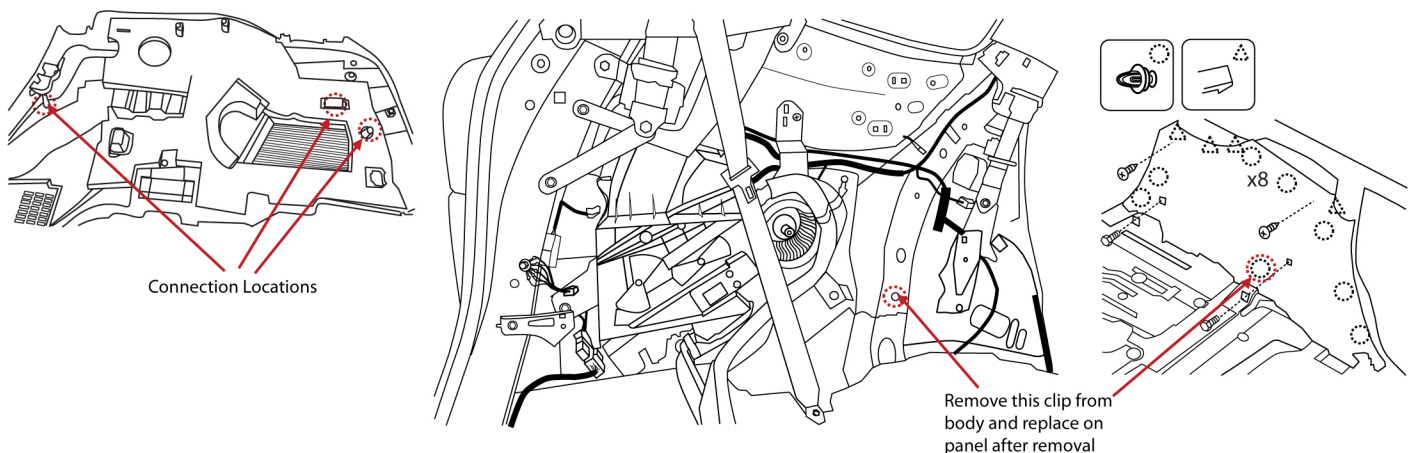

10. Lay the LH apron trim panel ASSY on a flat protected surface. Mark a straight "C" shape approximately 55mm x 55mm centered 25mm (1") below the clip mount. Use a razor blade to cut the insulation at the lines, creating a flap opening.

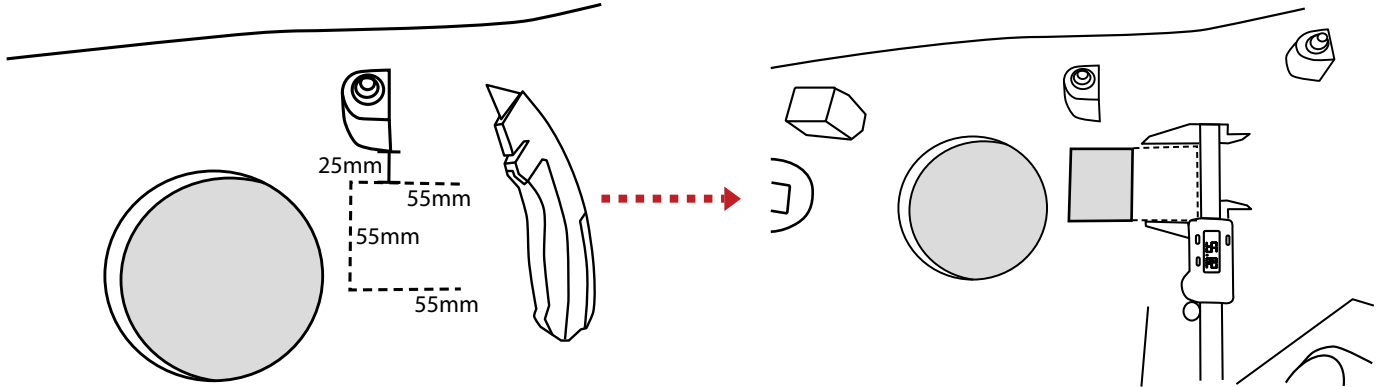

11. Flip panel over. Locate the pre-arranged marks in the grain of the panel. Use a center punch tool to mark the holes.

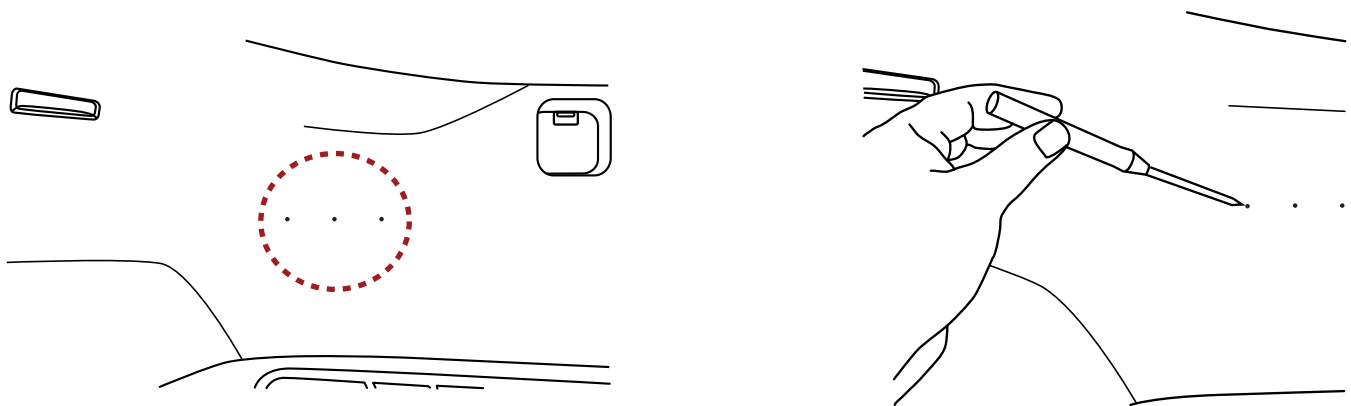

12. Set a drill stop collar on the 1/4" drill bit to a depth of 6-8mm. Carefully drill a 1/4" hole at each marked location.

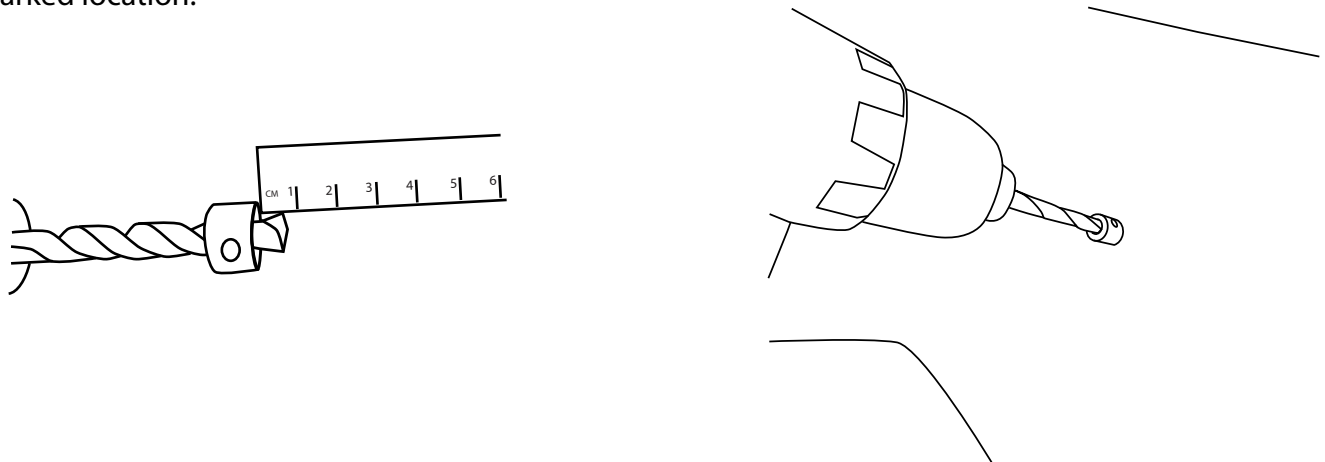

13. Use a shallow-depth 1-1/4" diameter hole saw to enlarge the center hole in the panel. Pull away any excess flashing.

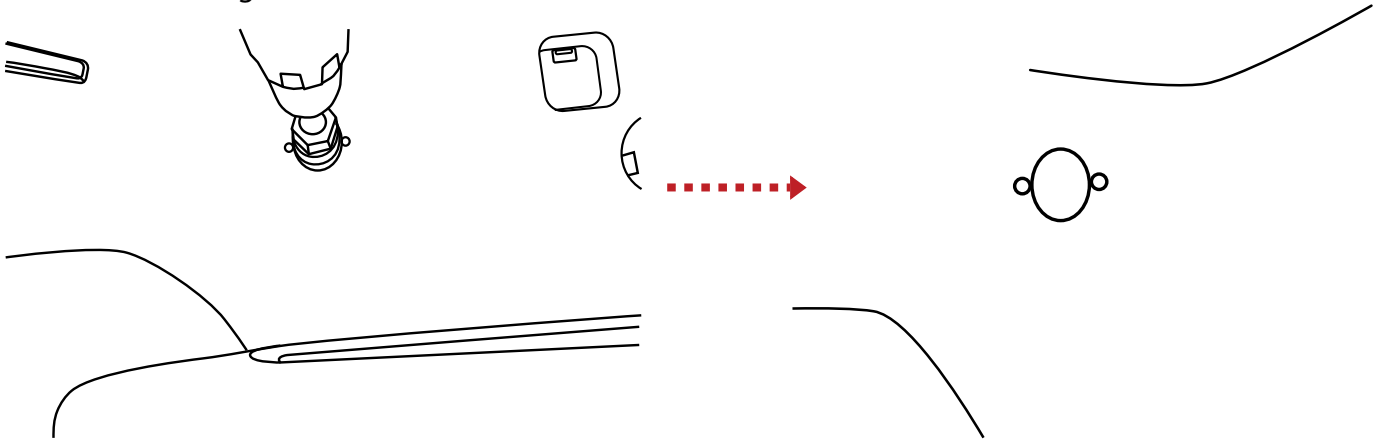

14. Route the harness as shown. Secure the harness with (4) wire ties at the white tape mark locations as shown (circles). Use (4) foam tapes to secure the harness to the floor as shown (arrows).

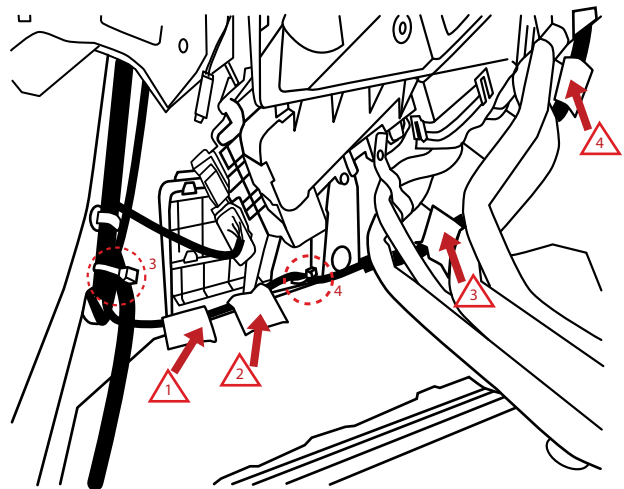
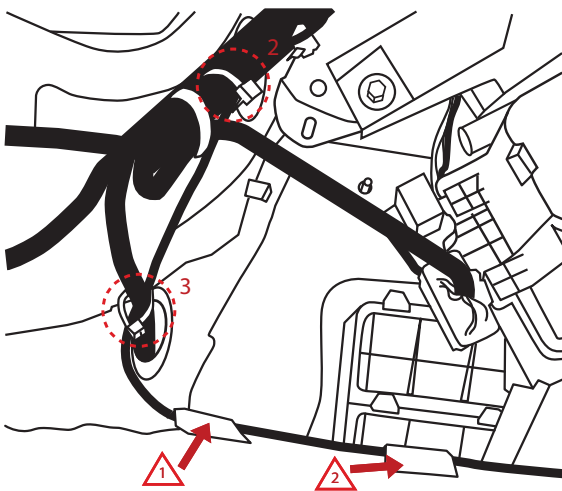
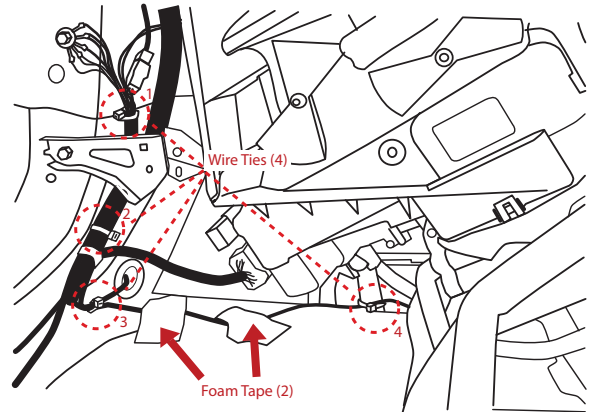
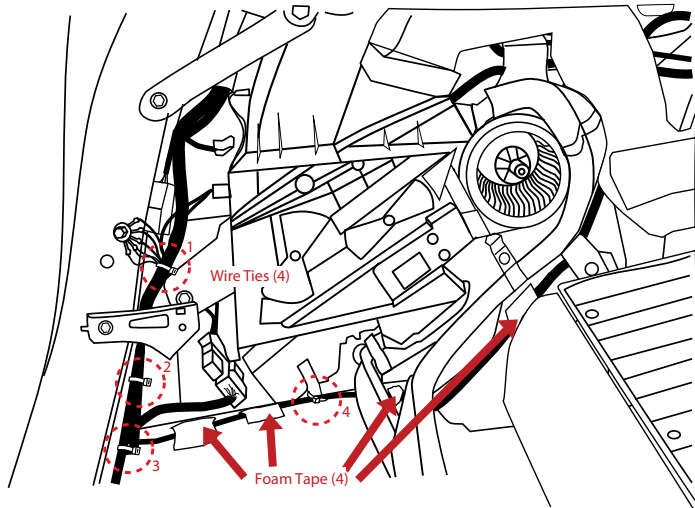

15. Re-install the LH trim panel ASSY according to the service manual. Feed the USB power harness through the large center hole. Insert (2) screw grommets into the 1/4" mounting holes.

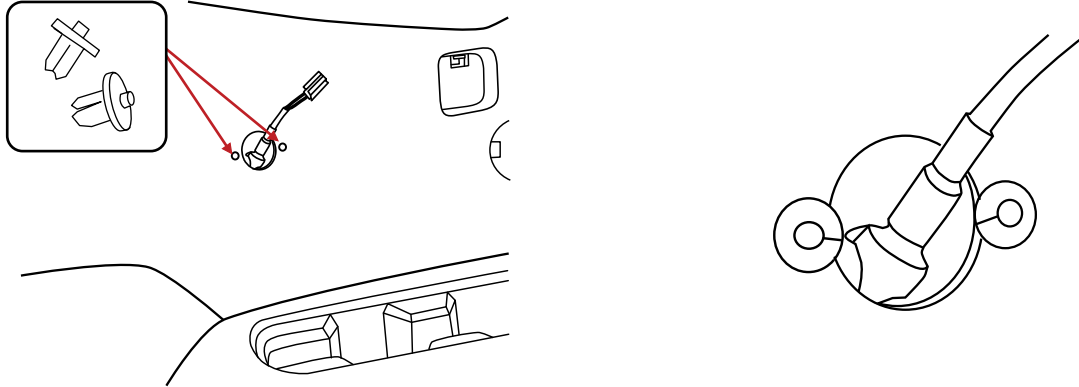

16. Connect the USB power harness to the USB charging port ASSY. Mount the USB charging port using the supplied (2) Philips screws. Align screw tip with screw grommet pin and push until pin engages with a "click" then tighten screws.

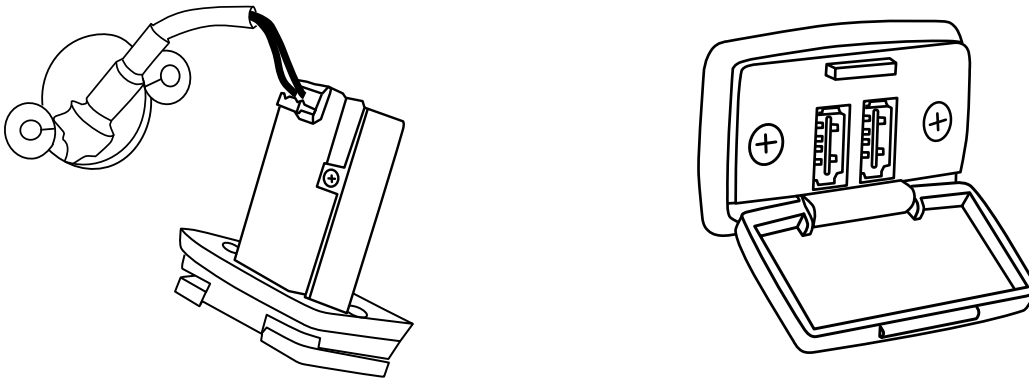

17. Connect the power harness to the vehicle side 12V aux connector. Connect other end to 12V auxiliary socket. Wrap the connectors in foam tape after connecting.

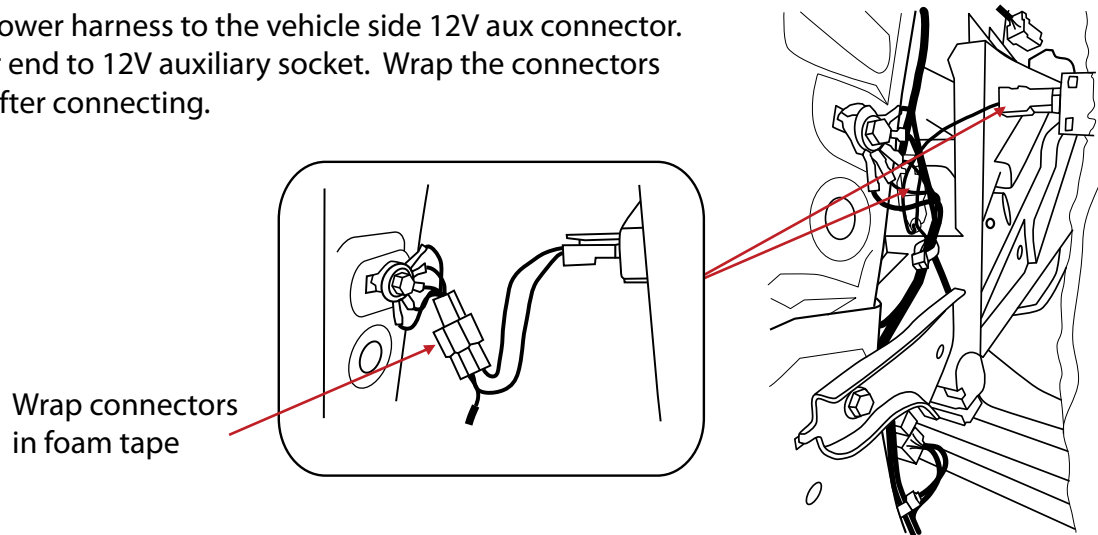

18. Re-install all panels and reverse order of removal. Reconnect negative battery terminal.

Note: Make sure LH apron trim is properly re-installed to vehicle and all clips are fully engaged.

