

2021MY Crosstrek Sport Grille Port Installation Instructions

P/N: J1010FL320



Ensure the VIN matches the work order, the vehicle due date is in the lock period, and verify there are no “Holds” on the vehicle for any reason. Verify the vehicle calls for the accessory installation.



Fog Light Kit installation is less difficult if combined with the Sport Grill Install because of improved access to the inside bumper cover.

CAUTION: ACCESSORY INSTALLATIONS PERFORMED BY UNTRAINED PERSONS COULD RESULT IN SERIOUS INJURY TO THOSE PERSONS OR TO OTHERS.

Subaru Work Instructions are intended for use by professional accessory installers ONLY. They are written to provide step by step accessory installation instruction for a fast paced production environment. Properly trained accessory installers have the equipment, tools, safety instructions and know-how to do the job correctly and safely. Included in this information are the use of “special” accessory installation fixtures and templates that are not available to the Retailers or general public. Please refer to the Retailer Installation Instructions found in Subaru Tech Info System (STIS).

SUBARU OF AMERICA, INC. IS “ISO 14001 COMPLIANT”

The international standard for excellence in Environmental Management Systems. Please recycle or dispose of automotive products in a manner that is friendly to our environment and in accordance with all local, state and federal laws and regulations.

2021MY Crosstrek Sport Grille Port Installation Instructions

Preparation

Kit Contents

- 1) Sport Grille
- 2) Camera Cover (For use on vehicles not equipped with front camera)
- 3) Sheet metal Screws (2)
- 4) Baffle "A"
- 5) Baffle "B"

Inspect the Sport Grille Kit for defects, damage, or missing items.

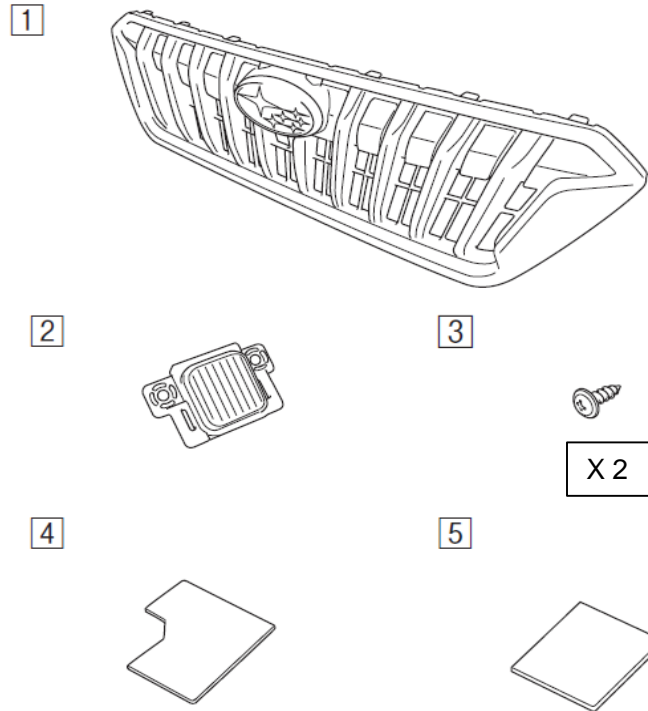

Stop: Damage may occur to the vehicle/part. Do not proceed until process has been complied with.



Work Hazard Analysis (WHA): Operator safety-Use caution to avoid risk of injury.



Caution: A process that must be carefully observed in order to reduce the risk of damage to the accessory/vehicle and to ensure a quality installation.



Revision Mark/Highlight: This mark highlights a change in installation with respect to the previous issue.



Work Instruction Training (WIT): Key point that designates an important step to ensure the quality of the installation.



Recycle: Item to be recycled.



Safety Torque - This mark indicates that a torque is related to safety

2021MY Crosstrek Sport Grille Port Installation Instructions

Required Tools

- #2 Phillips Screwdriver
- #1 Flat Blade Screwdriver
- Nylon Trim Tool
- Masking Tape
- ¼" Drive Torque Wrench
- ¼" Drive Ratchet with 10mm Socket and 6" Extension
- Torque Screwdriver with #2 Phillips Screwdriver Bit
- 50% Alcohol and 50% Water mixture in a spray bottle
- Clean Towels
- Table or support stand and a clean cover to support and protect the front bumper assembly during sport grille installation.



2021MY Crosstrek Sport Grille Port Installation Instructions

Preparation



While disconnecting the negative battery cable from the stud, hold the battery sensor in place with one hand while loosening the 10mm hex nut that secures the cable to the sensor. This will help support the sensor to prevent damage and also prevent the assembly from rotating on the battery post causing a poor connection. ⚠️

Open the hood and use the prop rod to hold the hood in the open position. While holding the battery sensor in place with one hand, use a 1/4" drive ratchet and 10mm socket to remove the negative battery cable from the negative battery stud. Do not remove negative cable from the battery post. Position / protect the negative cable so it cannot accidentally touch body ground or the negative the battery terminal. Allow (60) seconds before the next installation step to ensure the airbag power supply is discharged.

⚠️ Carefully remove the negative battery cable from the battery stud only. Do not allow the negative cable accidentally ground during the installation.

2021MY Crosstrek Sport Grille Port Installation Instructions

Preparation

1. Clean the front of the vehicle using a 50% solution of alcohol and water and dry the surface with a clean dry towel.
2. Apply masking tape on the fender where it meets the front bumper cover and under the headlights on both LH and RH sides to help prevent damage during bumper cover removal and reinstall.
3. Apply masking tape around the grille to help prevent damage during grille removal and install.

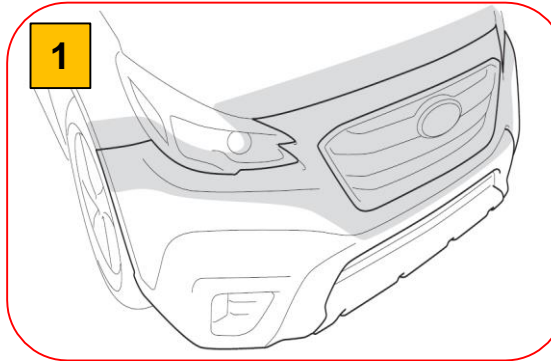

2021MY Crosstrek Sport Grille Port Installation Instructions

Disassembly

1. Using a nylon trim tool remove the (2) large clips on the top plate and save for reinstallation.
2. Using a ¼" ratchet and 10mm socket remove the (6) bolts along the top plate and save for reinstallation.
3. Using a nylon trim tool, remove the upper clips that retain the front bumper cover to the front fender on both LH and RH sides. (LH Shown)

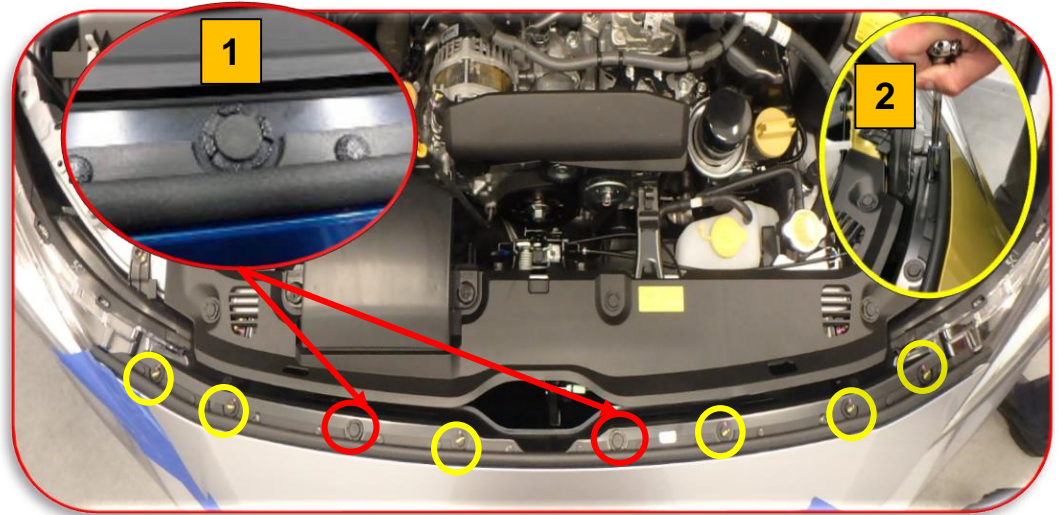

Use a nylon trim tool to push in on the center of the clip to release for removal.



2021MY Crosstrek Sport Grille Port Installation Instructions

Disassembly

1. Remove the (10) large retaining clips on the underside of the bumper cover and save for use during reinstallation.

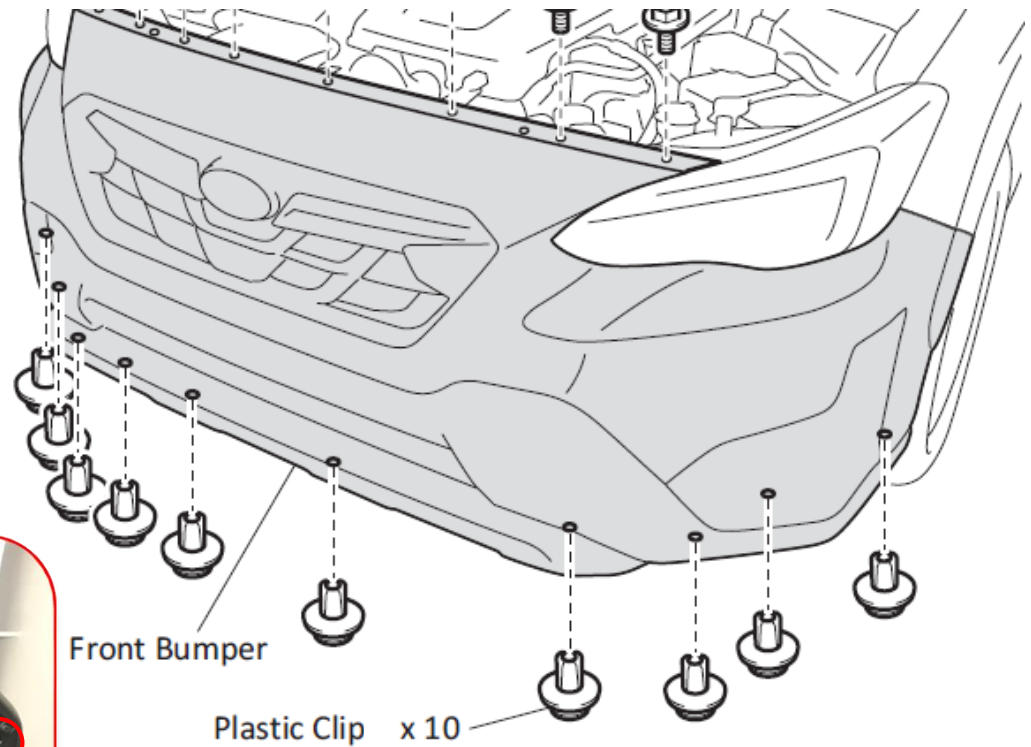
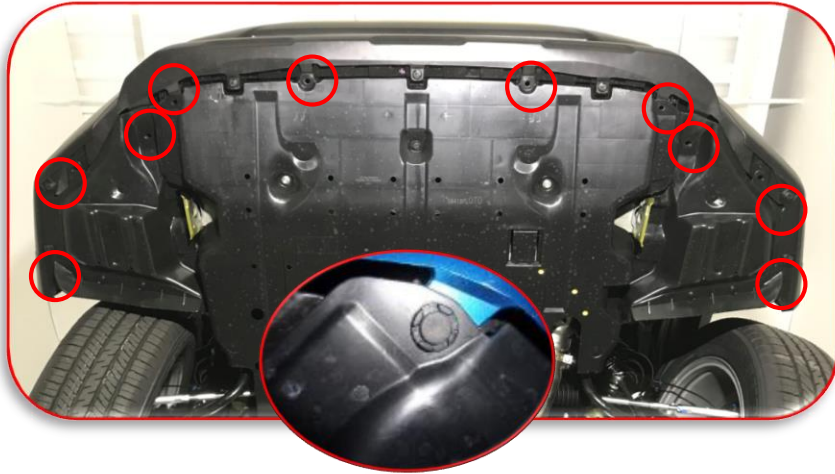

2021MY Crosstrek Sport Grille Port Installation Instructions

Disassembly

- 1) **For vehicles equipped with fog lights**, carefully pull down on the mud guard to gain access for disconnecting the fog light connector.
- 2) Reach up inside the bumper cover and disconnect fog light connectors on both LH and RH sides of the vehicle.

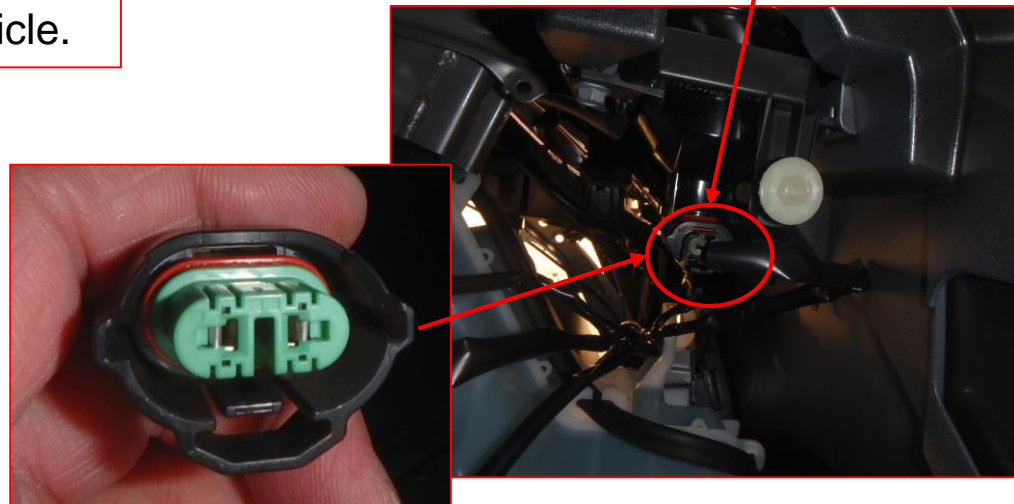
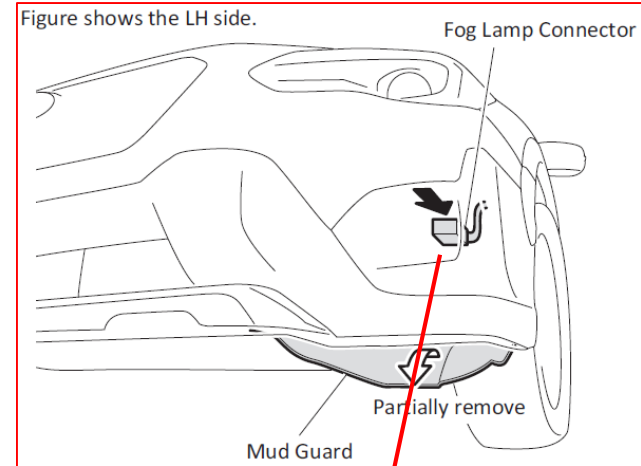

2021MY Crosstrek Sport Grille Port Installation Instructions

Disassembly

1. Carefully pull out on the sides of the front bumper cover to disengage tabs on the LH & RH sides of the vehicle.
2. Carefully pull forward on the front bumper cover to disengage the tabs on front bumper under the LH & RH headlights.
3. Lift away at the top and carefully lean forward.
4. While supporting the bumper cover with one hand, **disconnect the front camera if equipped.**
5. Carefully remove the front bumper cover from the vehicle and place the front bumper assembly on a clean protected table or support stand free of dirt or debris to prevent scratches or other damage.

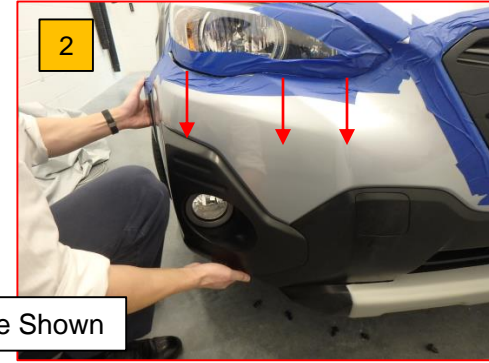
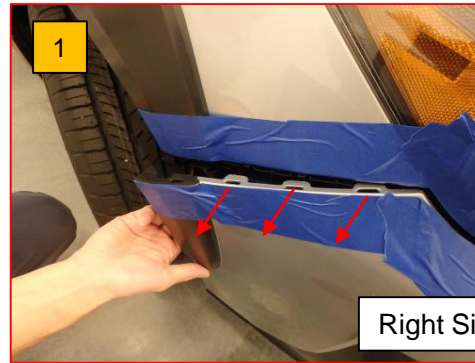

Right Side Shown

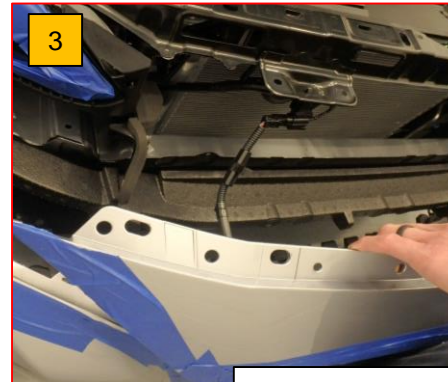

Illustrations show with front camera



2021MY Crosstrek Sport Grille Port Installation Instructions

Disassembly

- 1) Using a plastic trim tool, remove the (2) large clips from the intake duct and save for reinstallation.
- 2) Remove (3) large plastic clips from the upper bumper cover and save for reinstallation.
- 3) Pull upward on the intake duct to allow removal of the upper bumper cover.
- 4) Remove upper bumper cover for baffle installation.

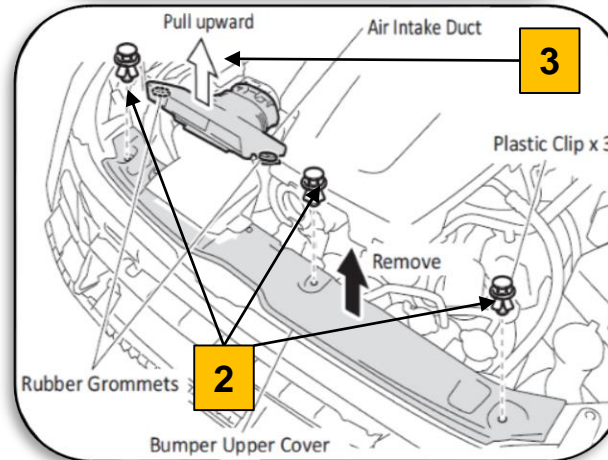
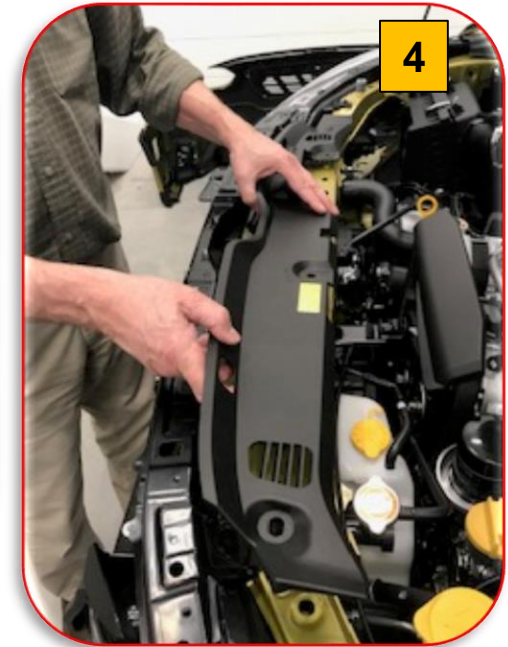

2021MY Crosstrek Sport Grille Port Installation Instructions

Installation (Baffle "A")

- 1) Using a 50% solution of alcohol and water, clean the lower area of the upper bumper cover then dry with a clean dry towel.
- 2) Measure on the upper bumper cover as shown in the illustration and apply masking tape as a guide for baffle installation. 
- 3) Peel the backing off of the baffle exposing the adhesive.
- 4) Align and attach the baffle edge at the measured 18mm point. While holding the baffle in place with one hand, pull the remainder of the baffle across while following the edge of the tape as a guide.
- 5) Press firmly along the baffle to ensure proper adhesion.

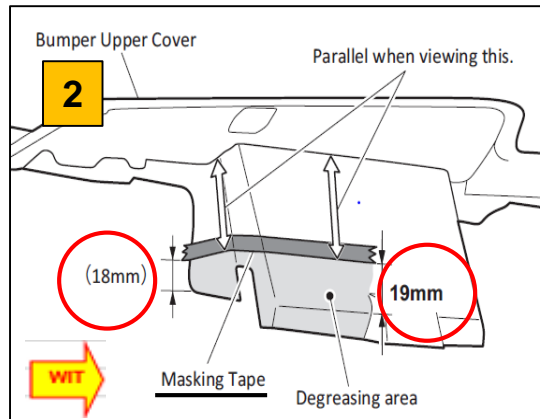

2021MY Crosstrek Sport Grille Port Installation Instructions

Installation (Baffle “B”)

- 1) Measure on the upper bumper cover as shown in the illustration and apply masking tape as a guide for baffle installation. 
- 2) Peel the backing off of the baffle exposing the adhesive.
- 3) Align and attach the baffle edge at the measured 20mm point. While holding the baffle in place with one hand, pull the remainder of the baffle across while following the edge of the tape as a guide.
- 4) Press firmly along the baffle to ensure proper adhesion.

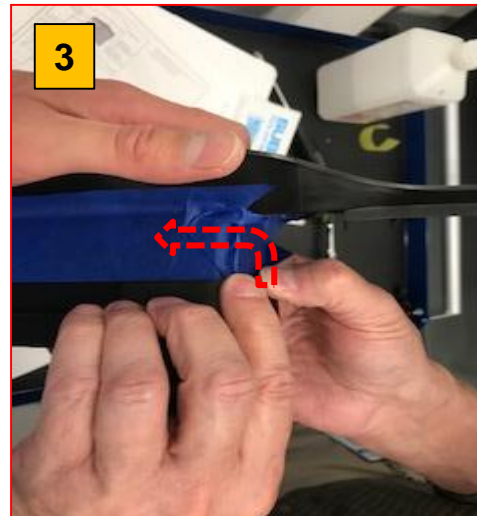
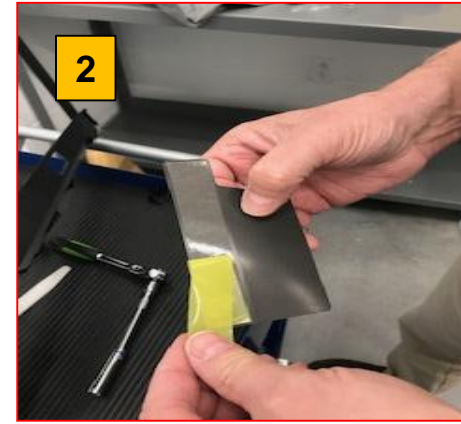
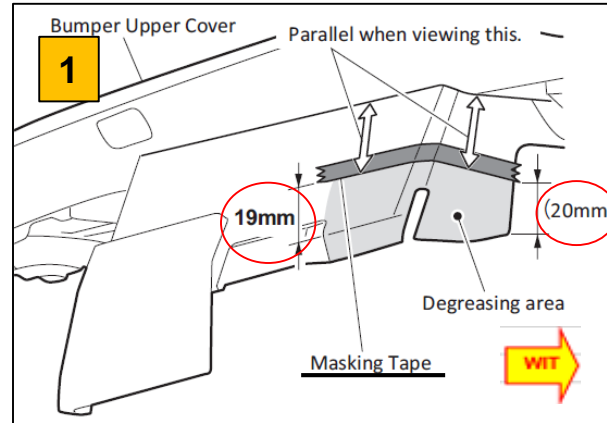

2021MY Crosstrek Sport Grille Port Installation Instructions

Reassembly (Bumper Upper Cover)

- 1) Remove masking tape.
- 2) With both baffles installed, lift up on the Air Intake Duct to allow installation of the Bumper Upper Cover.
- 3) Secure Bumper Upper Cover in place with (3) large plastic clips.
- 4) Fasten the Air Intake Duct with the (2) plastic clips

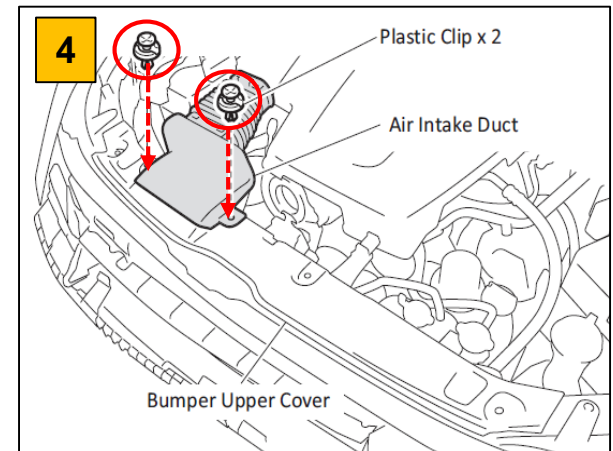
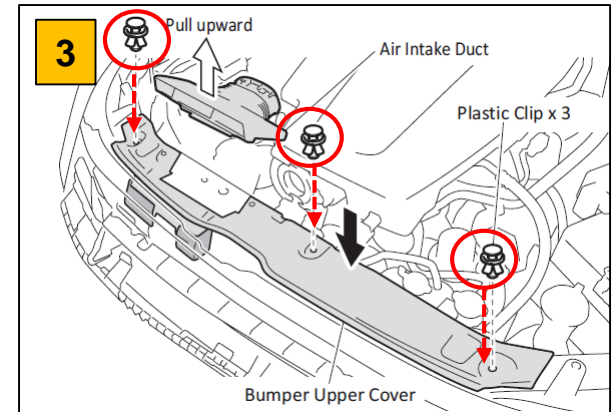
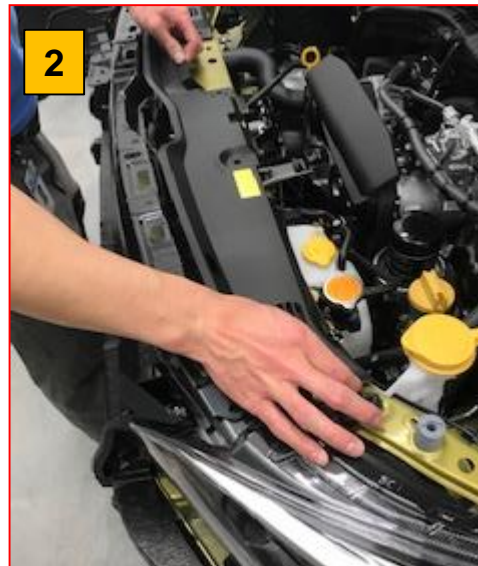
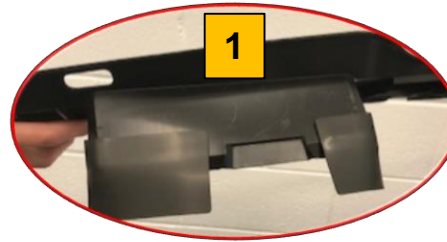

2021MY Crosstrek Sport Grille Port Installation Instructions

Disassembly (For Vehicles Equipped with Front Camera)

1. Using a #2 Phillips Screwdriver remove the (6) screws that hold the front grille in place. (Save screws for reinstallation)
2. Using a nylon trim tool carefully disengage the (8) claws and remove the O.E. grille from the bumper.
3. Place the OE grille face down on a clean protected surface.
4. Using a flat blade screwdriver disengage the (2) white harness clips from the grille.
5. Using a #2 Phillips Screwdriver remove and discard / recycle (2) screws securing the camera and remove the camera assy.
6. Properly discard / recycle the OE grille.

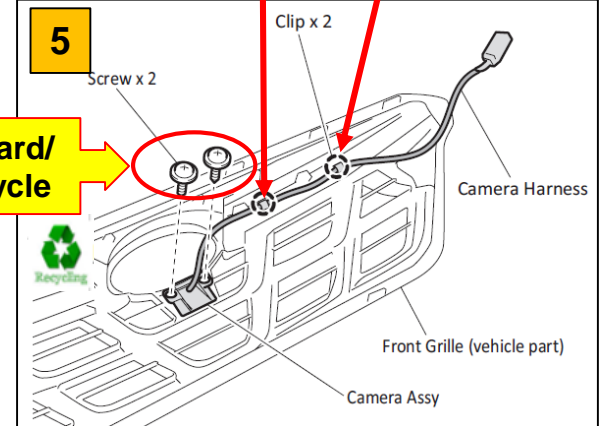
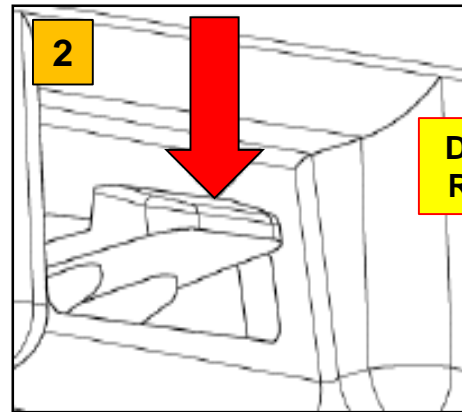
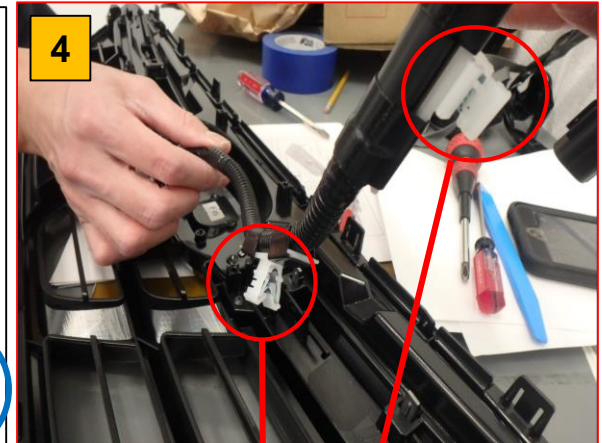
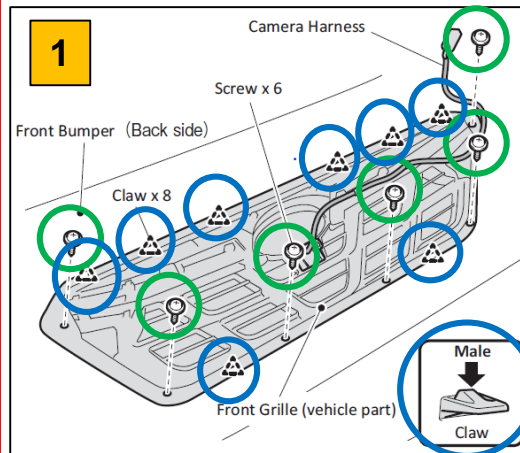

**Discard/
Recycle**

2021MY Crosstrek Sport Grille Port Installation Instructions

Disassembly (For Vehicles NOT Equipped with Front Camera)

1. Using a #2 Phillips Screwdriver remove the (6) screws that hold the front grille in place. (Save screws for later use during installation)
2. Using a nylon trim tool carefully disengage the (8) claws and remove the O.E. grille.
3. Properly discard / recycle the OE grille

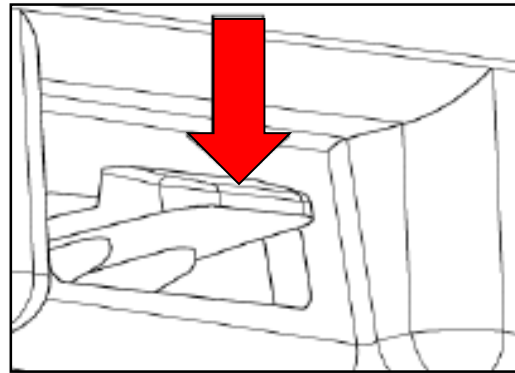
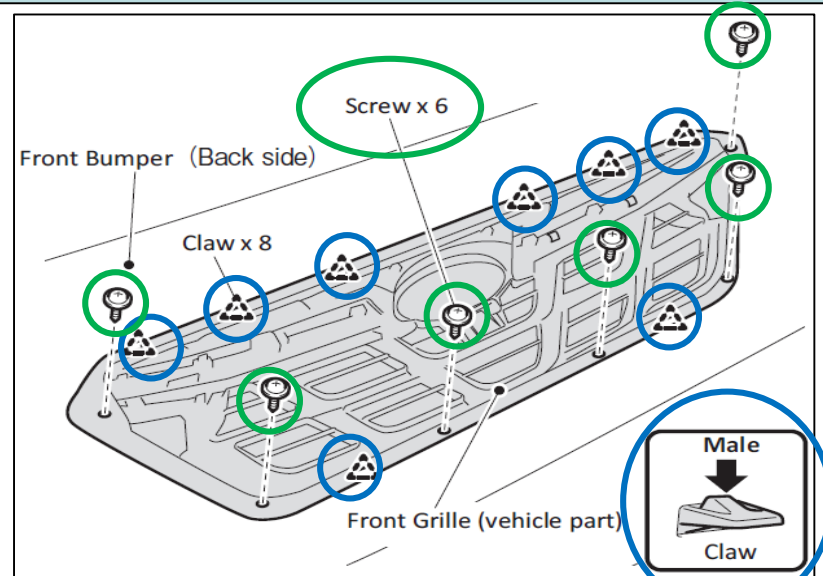

2021MY Crosstrek Sport Grille Port Installation Instructions

Sport Grille Installation

1. Place the Sport Grille on a clean protected surface.
2. **For vehicles equipped WITH front camera**, install the camera assembly previously removed to the Sport Grille using the (2) 4x12mm Screws provided in the Sport Grille Kit.
3. Torque the screws to 10 inch lbs. (Do not torque mark)
4. Secure the camera harness clips to the front grille.

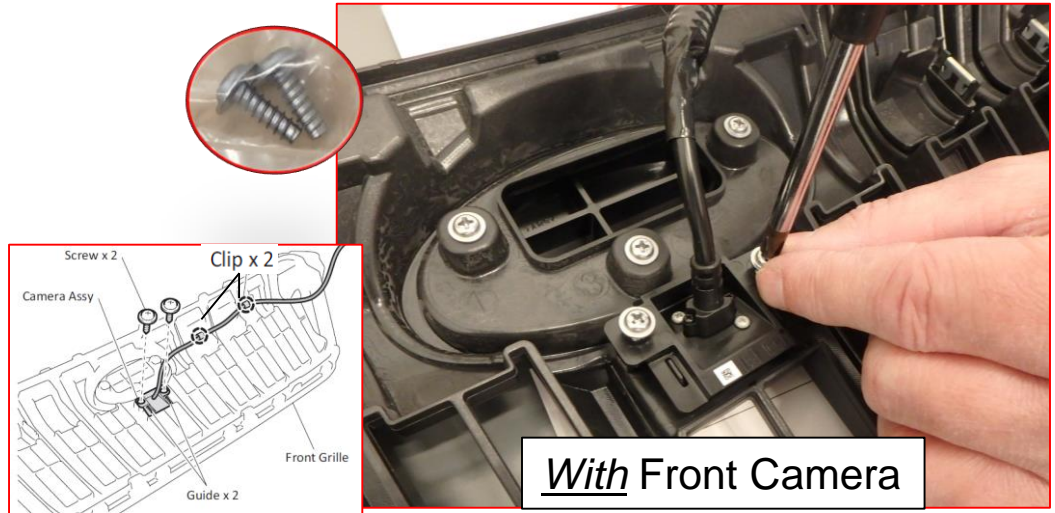

Sport Grille Installation

1. Place the Sport Grille on a clean protected surface.
2. **For vehicles NOT equipped with front camera**, install the Camera Cover provided in the Sport Grille Kit using the (2) 4x12mm screws also provided in the Sport Grille Kit.
3. Torque the screws to 10 inch lbs. (Do Not Torque Mark)

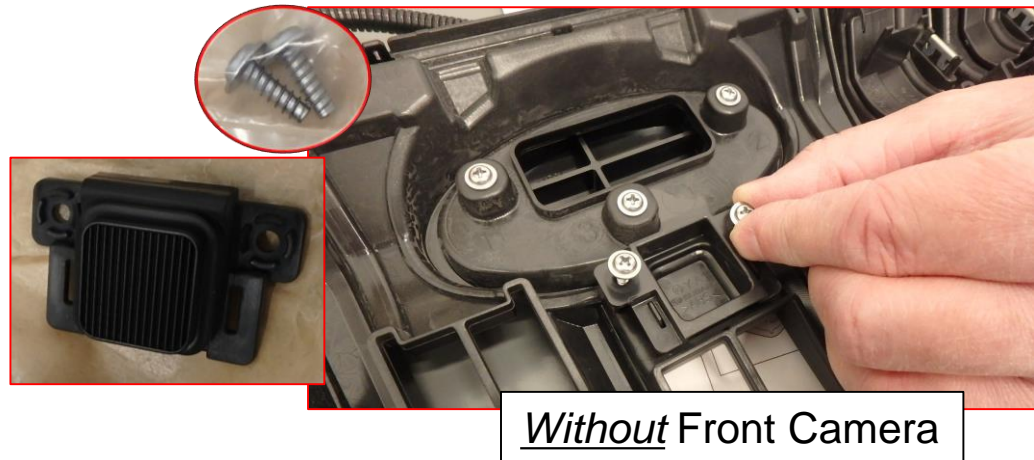

2021MY Crosstrek Sport Grille Port Installation Instructions

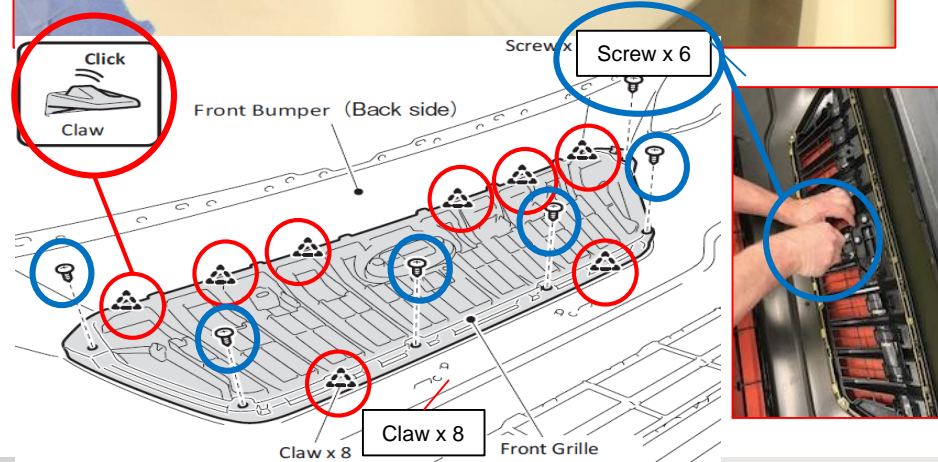
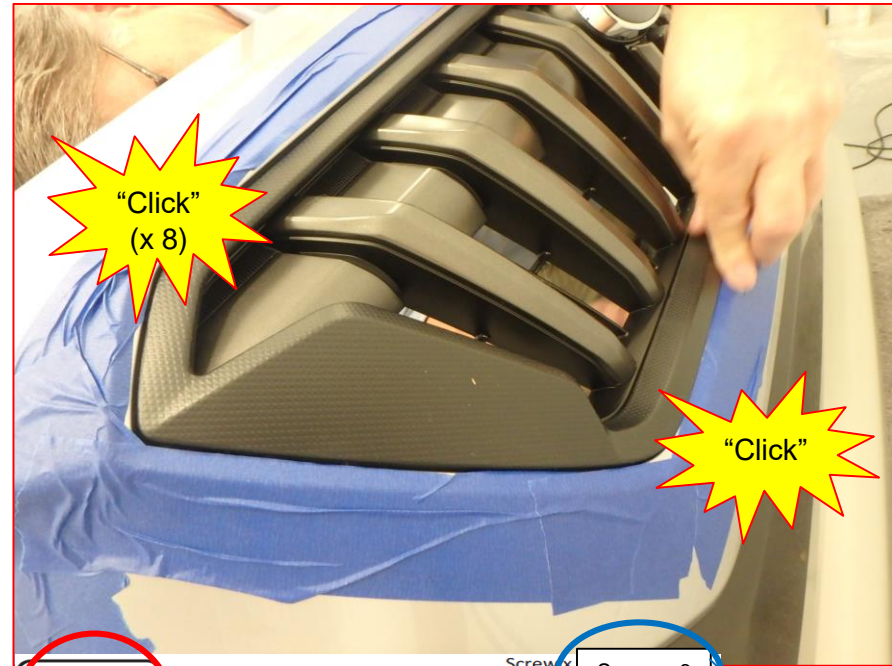

Sport Grille Installation

1. Carefully position the Sport Grille into the front bumper opening while aligning the (8) claw retention clips.
 Grille into the front bumper opening while aligning the (8) claw retention clips.
2. Apply pressure to the outside of the grille fully locking all (8) claw retention clips into place.
3. Using a #2 Philips head screwdriver, install the (6) screws previously saved during the OE grille removal procedure.
4. Torque all screws to 10 inch lbs. (Do Not Torque Mark)



2021MY Crosstrek Sport Grille Port Installation Instructions

Reassembly

1. Position the bumper cover at the front of the vehicle and guide into place starting at the top. (**Plug in the front camera connector if equipped**)
2. Verify proper alignment of the front bumper tabs to retaining claws under the headlamps before pushing into place. 
3. Push bumper into place under both headlights.
4. Verify proper alignment with the bumper tabs to retaining claws at RH and LH fenders before pushing into place. 
5. Push bumper into place on both LH and RH sides.
6. Verify the bumper cover is properly seated by confirming full engagement of all tabs in the retaining claws. 

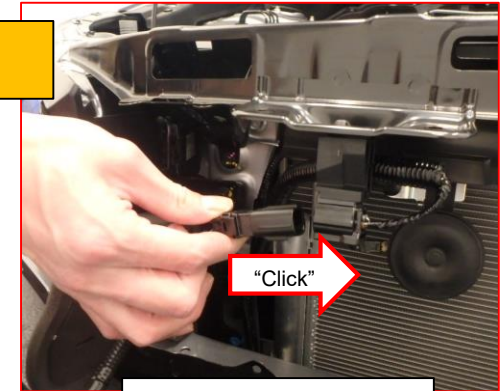
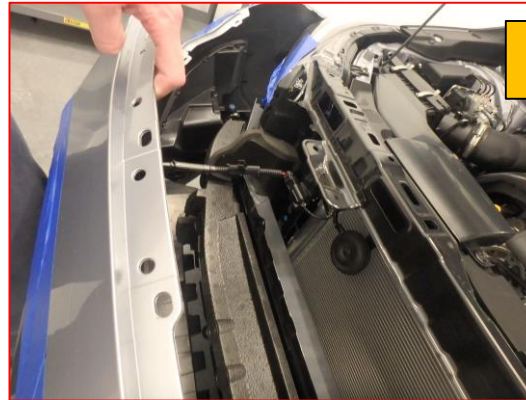

With Front Camera



Pushing the bumper into place with tabs not properly aligned with the claws will result in bumper damage. 

2021MY Crosstrek Sport Grille Port Installation Instructions

Reassembly

- 1) **For vehicles equipped with fog lights**, carefully pull down on the mud guard to gain access and reconnect the fog lights on both LH and RH sides of the vehicle.
- 2) **Verify proper orientation of the front bumper cover, fender liner and skirt on both RH and LH sides.**
- 3) Reinstall the 10 large clips on the bumper underside previously removed.
- 4) Reinstall the previously removed upper clips that retain the front bumper cover to the front fender on both LH and RH sides of the vehicle.

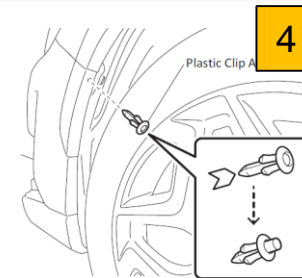
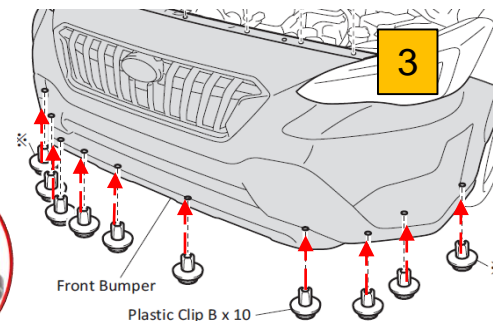
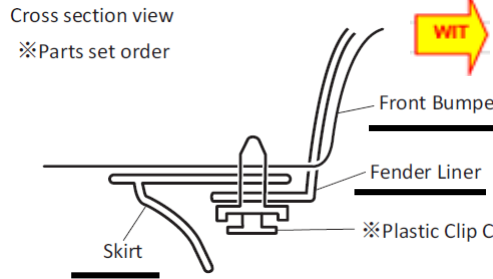
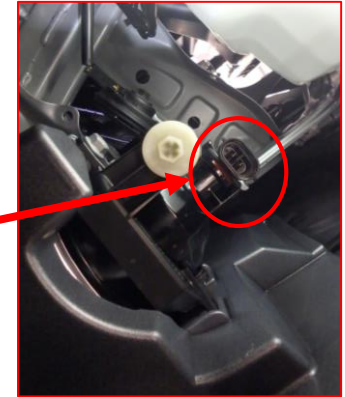
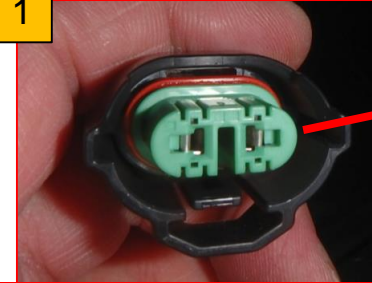
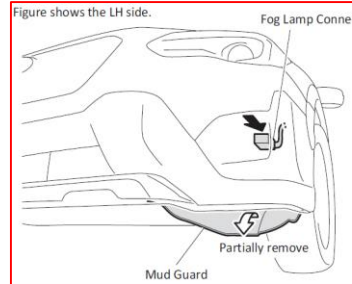

2021MY Crosstrek Sport Grille Port Installation Instructions

Reassembly

- 1) Reinstall the (2) large clips previously removed from the top plate.
- 2) Using a ratchet and 10mm socket reinstall the (6) bolts previously removed.
- 3) Torque all bolts to 66 inch lbs. (Do not torque mark bolts)

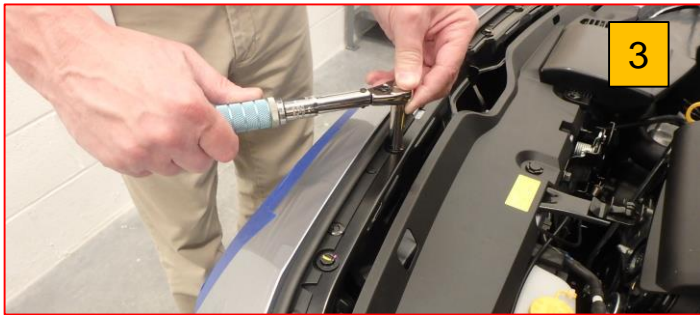
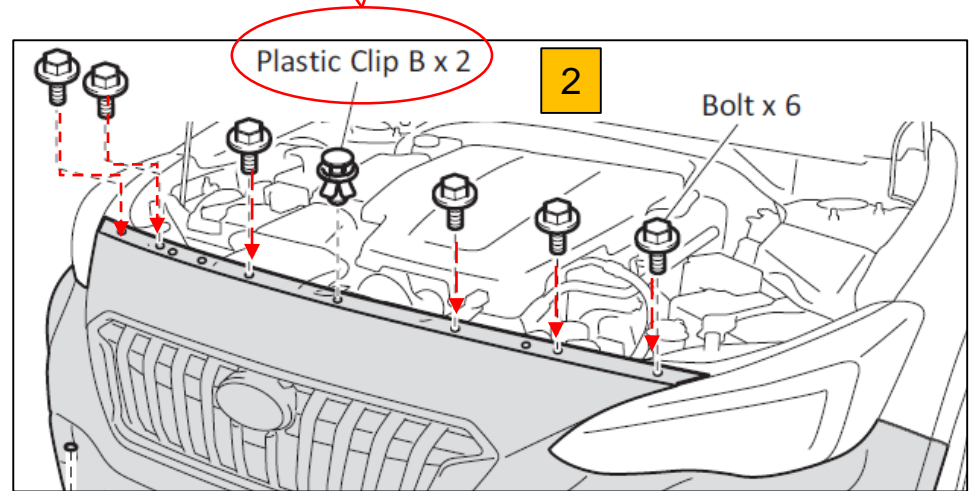
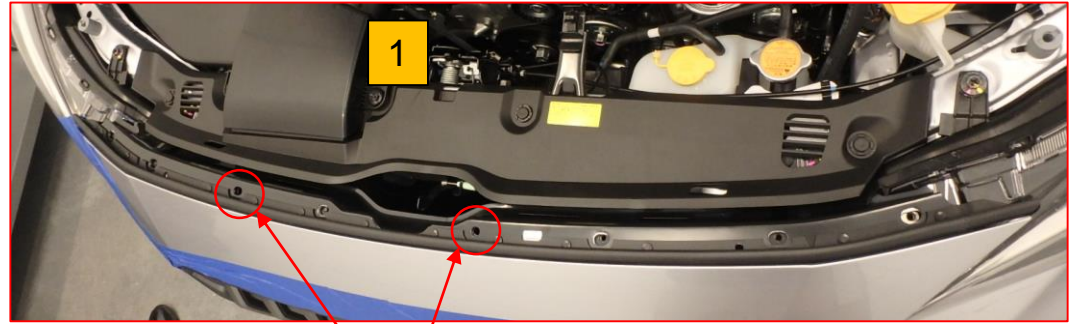

2021MY Crosstrek Sport Grille Port Installation Instructions

Reassembly

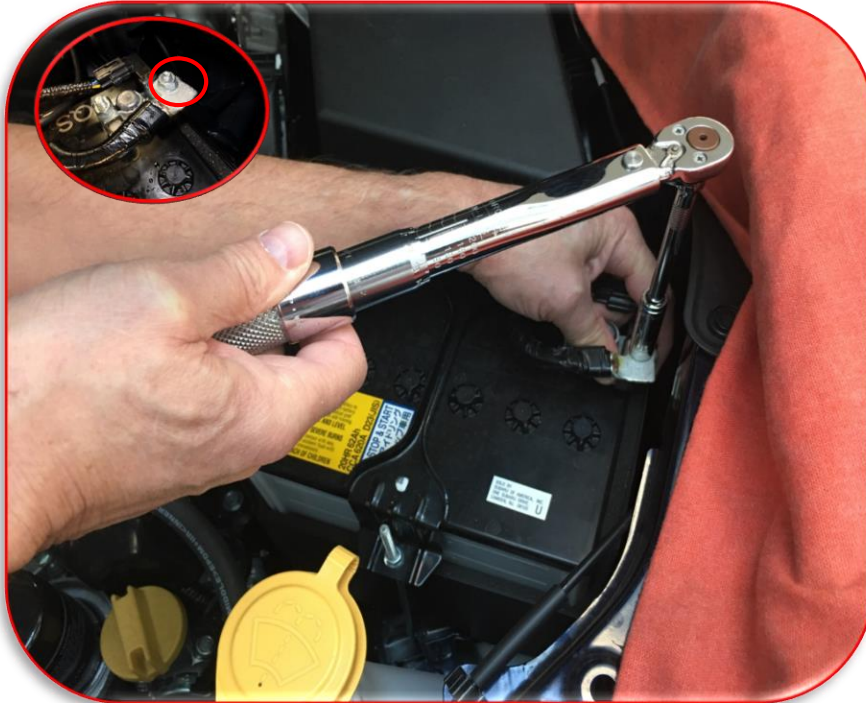

While connecting the negative battery cable to the stud, hold the battery sensor in place with one hand while  torqueing the 10mm hex nut that secures the cable to the sensor. This will help support the sensor to prevent damage and also prevent the assembly from rotating on the battery post causing a poor connection.

Re-connect the negative cable by reinstalling the saved 10mm nut on the stud. Use a ¼" drive torque wrench and a 10mm socket, tighten the cable nut to 66 In. Lbs. while holding the sensor to prevent damage and prevent the assembly from rotating on the battery post. Carefully disconnect the hood opening prop rod. Store the rod back into position under the hood. Close the hood.

 Carefully reinstall the negative battery cable to the battery stud only. Do not allow the negative cable accidentally ground during the installation.

**Torque mark
the battery
stud** 



2021MY Crosstrek Sport Grille Port Installation Instructions

Check Your Work Validation

Check the Power Window Up & Down Operation

If the power window automatic function does not operate properly, operate each window according to the following procedure in order to initialize the power window system.

1. Close the door.
2. Turn the ignition switch to the "ON" position.
3. Open the window completely and then press and hold down the power window switch for approximately (1) second.
4. Close the window completely and then pull and hold the power window switch for approximately (1) second.
5. Confirm the power window automatic functions operate properly.

▼ Operating the window

- With one-touch auto up and down feature:

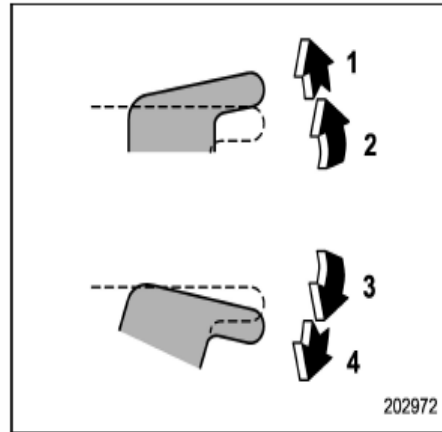

- 1) Automatically close*
- 2) Close
- 3) Open
- 4) Automatically open*

*: To stop the window halfway, operate the switch to the opposite side.

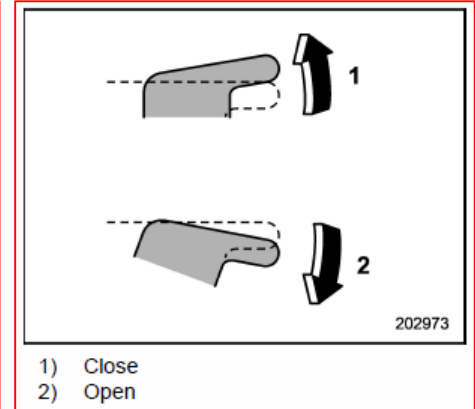

- 1) Close
- 2) Open



2021MY Crosstrek Sport Grille Port Installation Instructions

Check Your Work Validation

- ✔ Ensure the sport grille is properly positioned and fully seated in the front bumper cover.
- ✔ Check the gaps under the head lights, fender to bumper and ensure the bumper cover is fully seated and damage free (no scratches or paint chipped edges, etc.)
- ✔ Ensure the top panel and intake duct are properly reinstalled in place.
- ✔ Ensure the hood closes properly.
- ✔ Turn the ignition “on” and verify proper operation of the fog lights if equipped.
- ✔ Verify proper operation of the front camera if equipped.
- ✔ Verify Auto up/down window feature operates as designed.
- ✔ Verify all clips are properly reinstalled and bolts torqued (not torque marked).

2021MY Crosstrek Sport Grille Port Installation Instructions

Document History

<u>Revision</u>	<u>Date</u>	<u>Slide#</u>	<u>Description</u>	<u>Author</u>
A	6/5/2020	N/A	Original Release	RM