



SUBARU

INSTALLATION INSTRUCTIONS

SUBARU

PART NUMBER: J101SFL500xx

DESCRIPTION: BODY SIDE MOLDING KIT, DEALER

Vehicle and all installation material temperatures must be within the following range before and during installation: 60° F [15° C] and 100° F [43° C].

KIT CONTENTS:

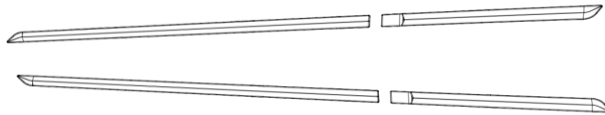

Front Left + Rear Left
Body Side Molding
(with Tape)

Front Right + Rear Right
Body Side Molding
(with Tape)



Paper Installation Templates
(Front Door- Large,
Rear Door- Small)



Isopropyl Alcohol
Packets (4 per Kit)

TOOLS REQUIRED:



Rubber Roller for Installation

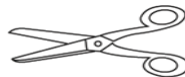

Scissors



Painter's Tape

MEANING OF CHARACTERS:

: CAUTION – A process that must be carefully observed in order to reduce the risk of damage to the accessory/vehicle and to ensure a quality installation.

: STOP - Damage to the vehicle may occur. Do not proceed until process has been complied with.

: TOOLS & EQUIPMENT - Specific Tools and equipment recommended for this process.

STEP ONE: Align the paper installation template on the vehicle door

1a

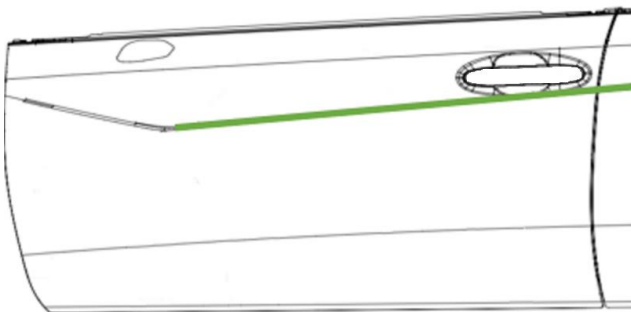

Locate the Door Feature Line on the Front Door of the vehicle.

1b

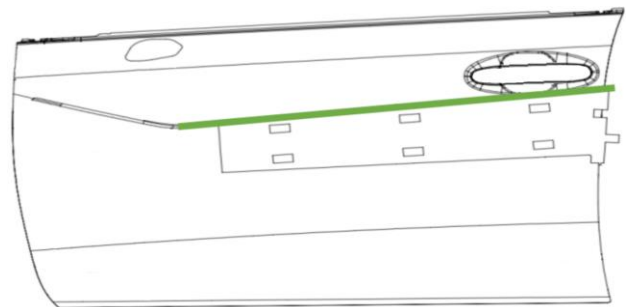

Align the Front BSM Template on the door, level with the Door Feature Line.

1c

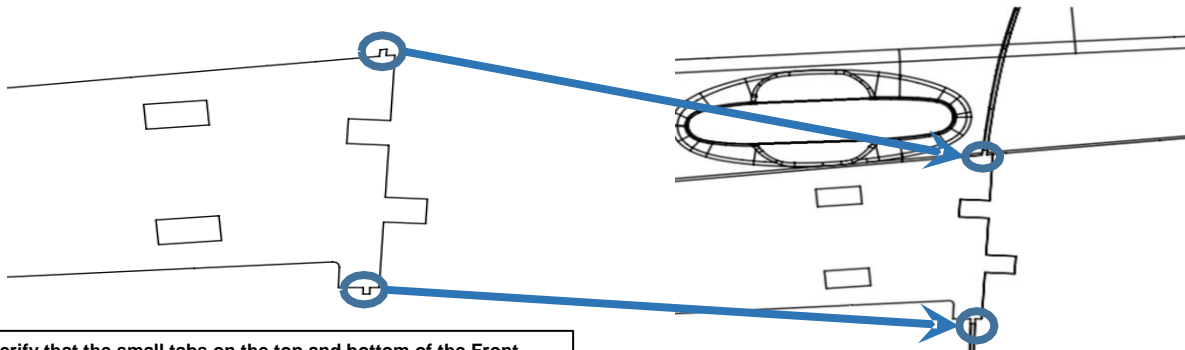

Verify that the small tabs on the top and bottom of the Front Template are lined up in the door gap.

PART NUMBER:
J101SFL500xx

ISSUE:
REV A

DATE:
07-25-16

SUBARU OF AMERICA

PAGE
1/5

STEP ONE (Continued): Align the paper installation template on the vehicle door

1d

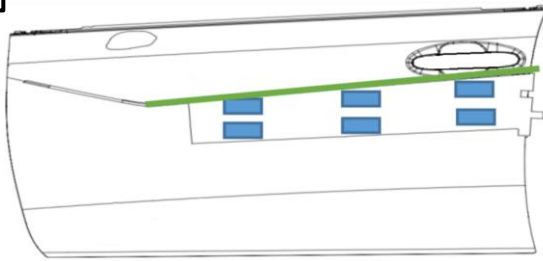

Cut off a piece of Painter's Tape (low adhesive tape) to adhere the Front Door (LH) template into place, using the Six (6) Taping Squares provided in the template.

1e

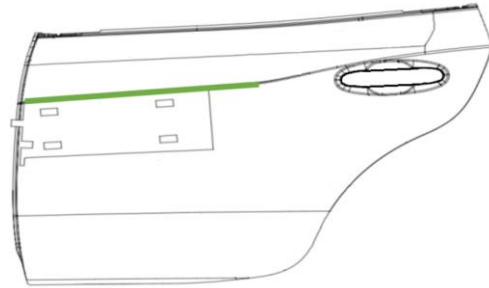

Align the Rear BSM Template on the Rear door, level with the Door Feature Line, but do not tape prior to steps 1f and 1g.

1f

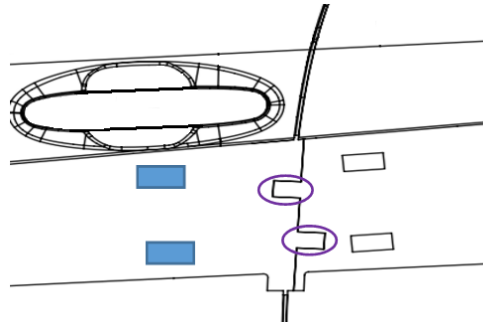

Ensure Center Tabs of Front and Rear Templates Align before taping the Rear Template into place on the vehicle.

*****IMPORTANT*****
Maintain alignment with Door Feature Line.

1g

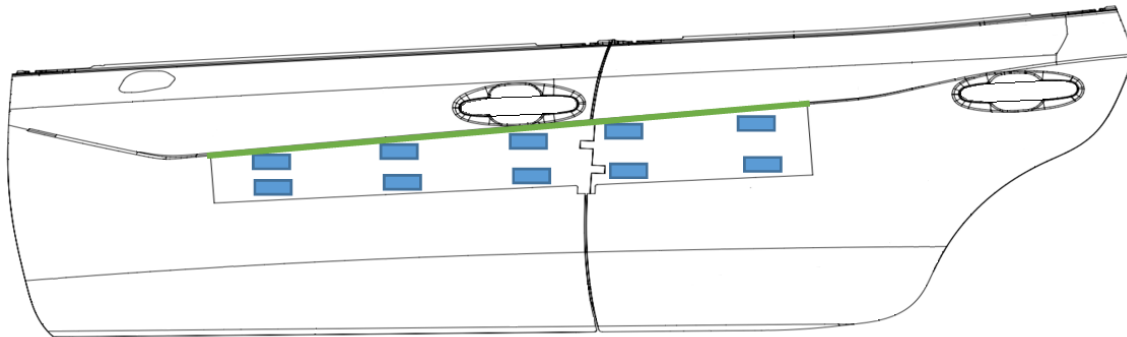

After steps 1e and 1f are completed and verified, tape the Rear Template (small template) into place using Low Adhesive tape. Ensure alignment with the Door Line Feature is maintained during this process.

1h

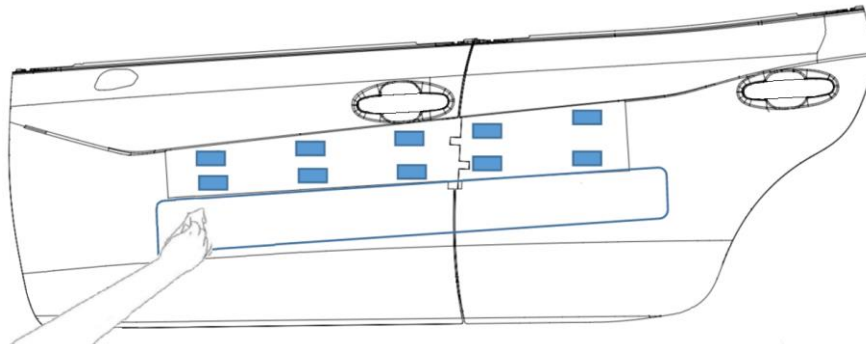

Thoroughly clean the Body Side Molding installation area with an alcohol packet (1 wipe per door).

*****IMPORTANT*****
PREP DOOR SURFACE IN TEMPLATE AREA WITH ISOPROPYL ALCOHOL

STEP TWO: Installing the Body Side Molding

2a

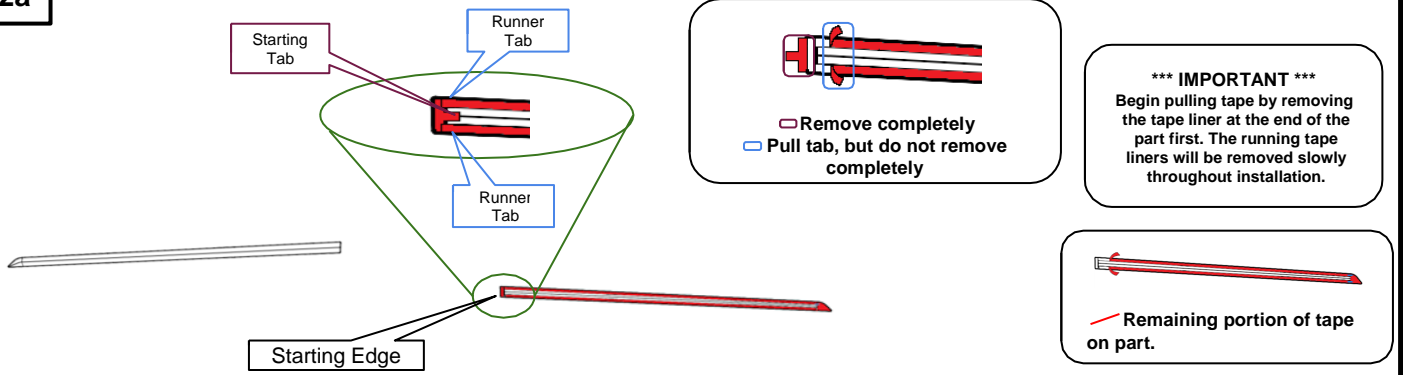

Begin with the Front Door (LH) Body Side Molding. Begin installation by pulling the starting tape liner tab (—) located on the backside of the part. Carefully pull the starting tape liner tab through the part to completely remove the tape liner. Cautious when removing the starting tape liner, the running tape liner tabs (—) do not stick to the, now visible, tape. Once the starting tape liner has been removed, begin pulling each of the running tape liner tabs, (—). Pull the running tape liners tabs back approximately 4 to 5 inches.



2b

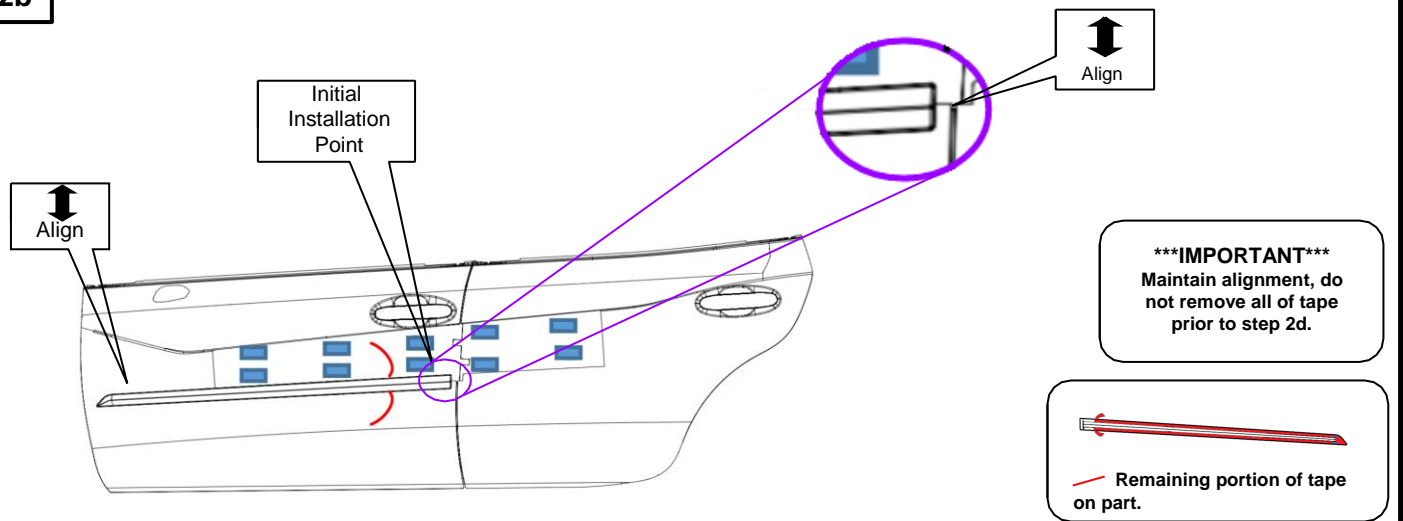

Align Front Door (LH) Body Side Molding along the front template (big template). The top edge of the BSM should align with the bottom edge of the Front Template. With one hand holding the BSM in proper alignment, use the other hand to gently press the BSM onto the vehicle at the initial installation point.



2c

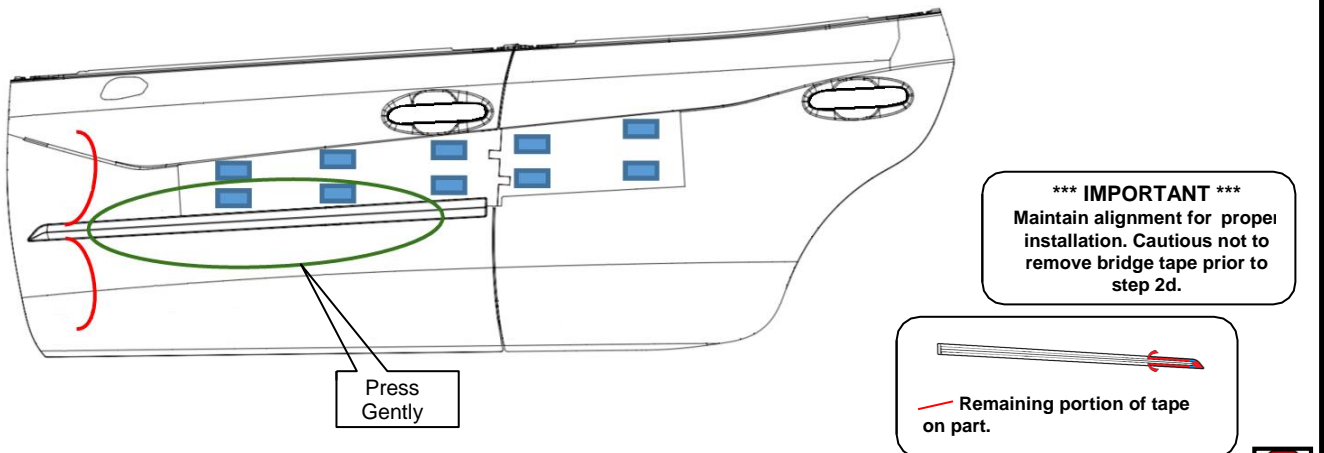

Holding the Body Side Molding in proper alignment with one hand, continue removing the running tape liner (2) until it is approximately 3/4 of the way through the part. Still holding the BSM in proper alignment, gently press down on the center of the BSM engaging the part.



STEP TWO (continued): Installing the Body Side Molding.

2d

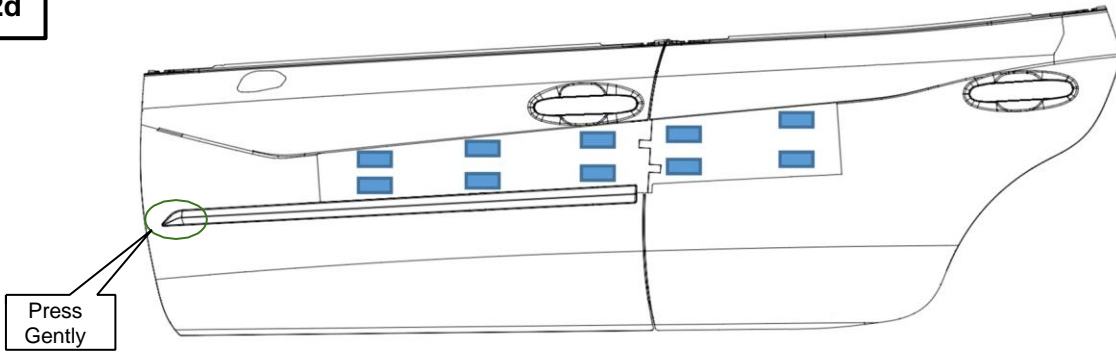

*****IMPORTANT*****
Peel tape liners back slowly to ensure the bridge tape and tape liners are removed correctly.

To complete the installation of the BSM, grasp a piece of running tape liner in each hand and slowly pull through the end of the part. Cautious when pulling the tape liners that the bridge tape and the final piece of tape liner at the nose of the part is removed properly. Gently press the entire part against the vehicle to ensure proper alignment.



2e

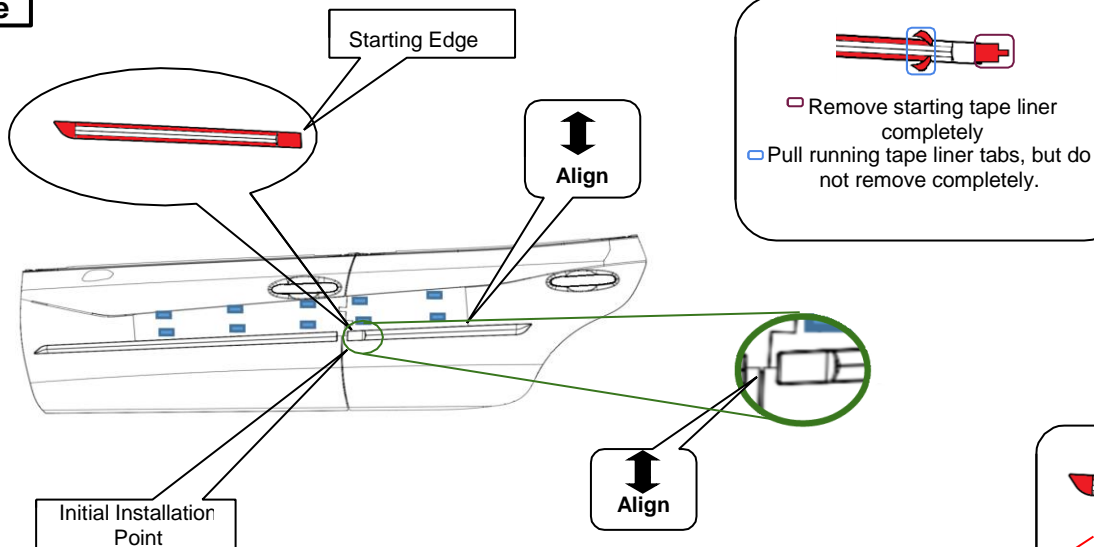

***** IMPORTANT *****
Begin pulling tape by removing the tape liner at the end of the part first. The running tape liners will be removed slowly throughout installation.

Remaining portion of tape on part.

Repeat steps 2a through 2d to install the Rear Left Body Side Molding. Ensure that the rear template (small template) is used when aligning the BSM.



2f

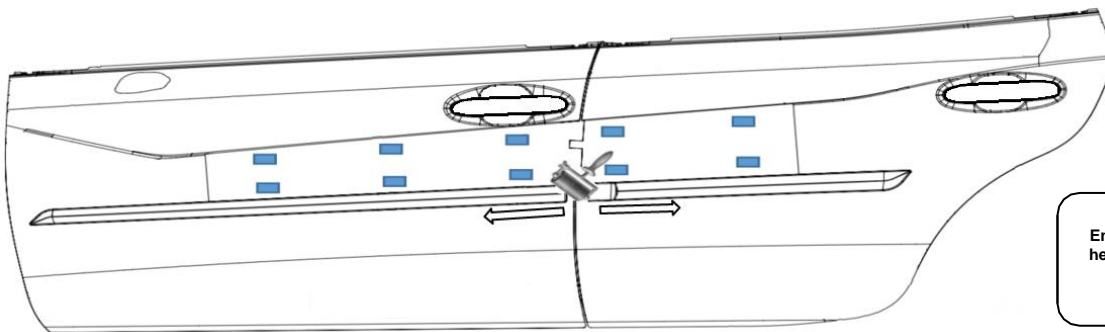

*****IMPORTANT*****
Ensure that the rubber roller is held perpendicular to the Body Side Molding for proper installation.

REPEAT ALL DOORS



Once step 2d & 2e have been completed and verified, use the rubber roller to ensure the Body Side Molding is properly installed. Firmly (with 15 lbs / 6.8 kgs) roll the rubber roller across the part to properly set the Body Side Molding in place. Roll across the part in the same direction as the tape liner was removed.



STEP TWO (continued): Installing the Body Side Molding.

2g

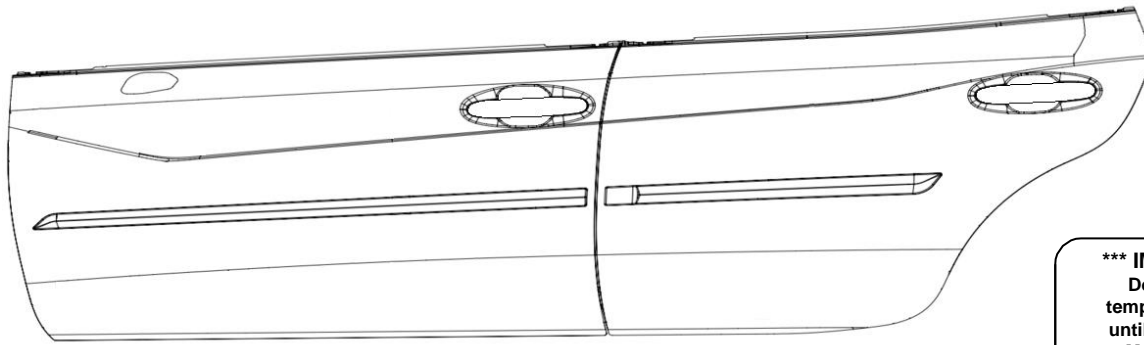

***** IMPORTANT*****
Do not remove
templates, and tape
until the Body Side
Molding is fully
engaged.

Once steps 2a through 2f are completed and verified, cautiously remove the paper templates from the door, one at a time. To remove each template, slowly remove the painter's tape, being careful not to damage the template. Remove the template from the door, flip over, and repeat steps 1 & 2 to install Right Hand Body Side Molding.

**REPEAT ALL
DOORS**

